

DISCLOSURE PLAN  
PROPOSED LOT 233

This plan is to be read in conjunction with the disclosure statement prepared for this lot.

Cancelling part of Lot 1003 on SP298957 and  
Lots 1 & 2 on RP79384  
Locality of Narangba

- These notes form an integral part of this plan. No part of this plan may be reproduced without these notes being included.
- All dimensions and areas shown are subject to final survey and relevant local authority approval.
- This plan has been prepared for issue to a buyer as a disclosure plan under the Land Sales Act 1984. It is not to be used for any other purpose.
- Levels and contours shown on this plan are not to be used for building design or construction; a topographical survey of the site is required.
- Any engineering detail (retaining walls, etc.) shown on this plan is indicative only and subject to construction and relevant local authority approval.
- For further detail regarding services, facilities and features which may have relevance to the proposed lot, reference should be made to the Development Application approval conditions, the approved operational works drawings and current engineering drawings.

Contour Interval – 0.5 metre

- 50.0— Design Contours
- Retaining Wall (Due to plotting limitations the retaining walls shown are not to scale and are indicative only)
- HW 1.0  
LW 0.2  
AW 0.8
- Height of Highest Point of Wall (Metres)  
Height of Lowest Point of Wall (Metres)  
Average Height of Wall (Metres)

Compaction of fill will be done in accordance with Australian Standard AS 3798–2007, under Level 1 inspection and testing by the nominated Geotechnical Inspection and Testing Authority.

- x0.1 Cut/Fill, calculated between design and existing surface contours
- Area to be Cut, as supplied by RMA Engineers
- Area to be Filled, as supplied by RMA Engineers

Lot levels and earthworks derived from Engineering Drawings.

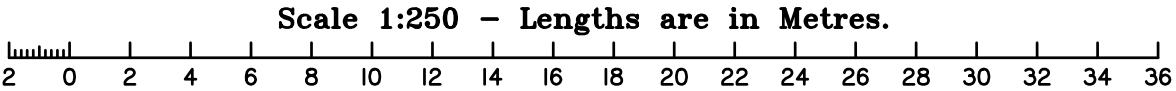
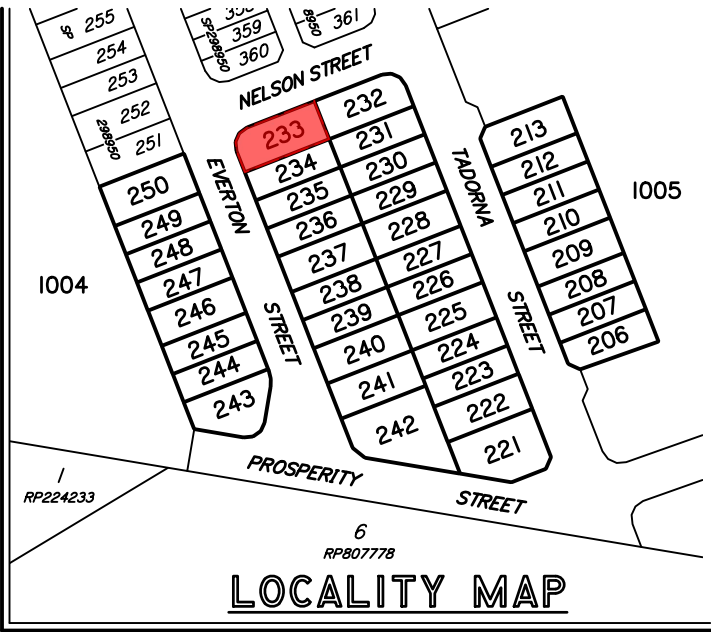
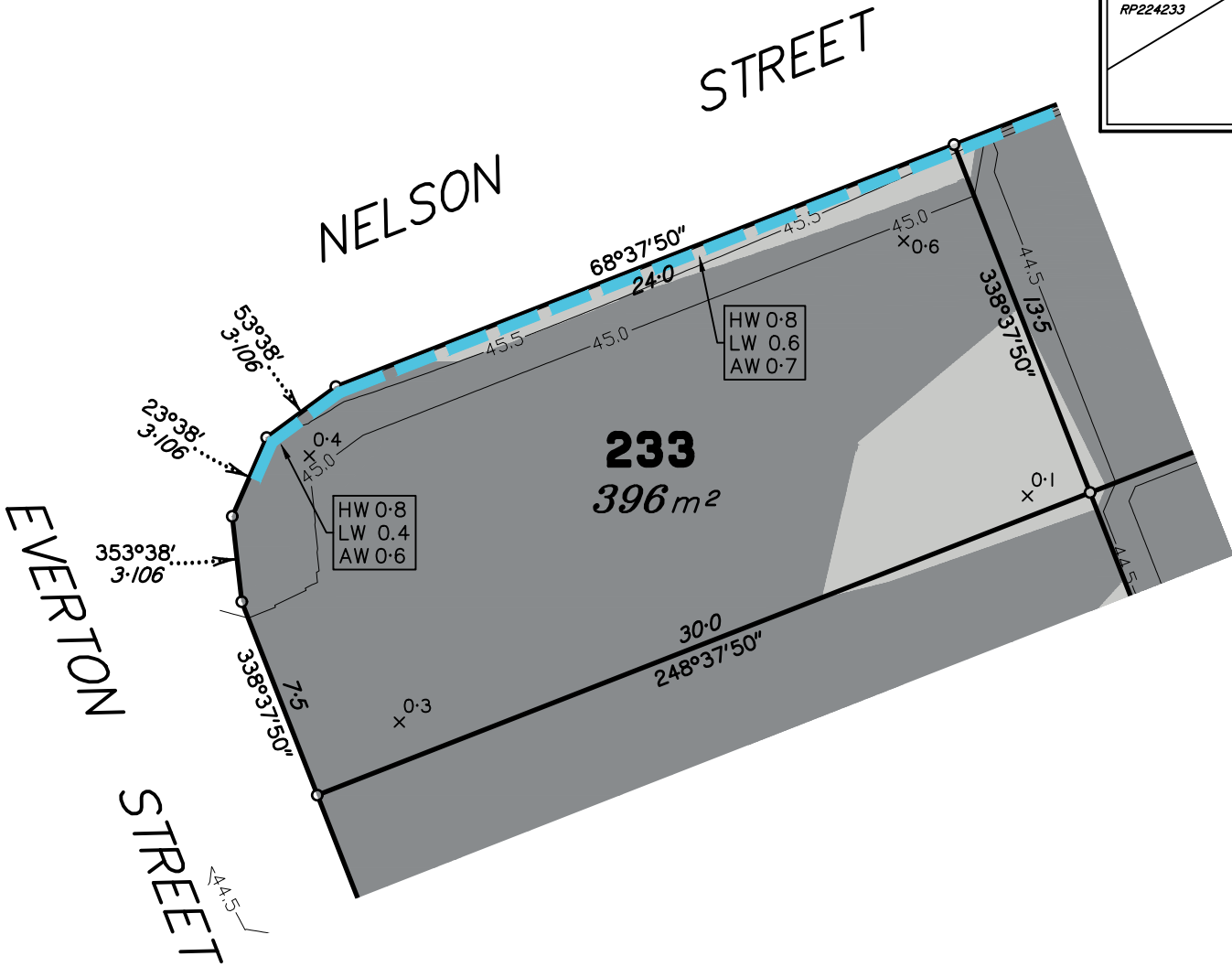

Meridian: MGA Zone 56 ☒ Yes ☐ No  
Contour Height Datum: AHD

B A	UPDATE CIVIL DESIGN INFORMATION ORIGINAL ISSUE	21/07/20 15/01/20	AA AA	AV AV
Issue	Details	Date	Drawn	Checked

DISCLOSURE PLAN  
DAHUA POINTCORP NARANGBA PTY LTD  
STAGE 8A "AMITY"  
CALLAGHAN ROAD, NARANGBA

Dwg No: A3–5928/233	Issue: B
Project: BNE150725	
File: B150725Dis8A.dwg	

DISCLOSURE PLAN  
PROPOSED LOT 234

This plan is to be read in conjunction with the disclosure statement prepared for this lot.

Cancelling part of Lot 1003 on SP298957 and  
Lots 1 & 2 on RP79384  
Locality of Narangba

- These notes form an integral part of this plan. No part of this plan may be reproduced without these notes being included.
- All dimensions and areas shown are subject to final survey and relevant local authority approval.
- This plan has been prepared for issue to a buyer as a disclosure plan under the Land Sales Act 1984. It is not to be used for any other purpose.
- Levels and contours shown on this plan are not to be used for building design or construction; a topographical survey of the site is required.
- Any engineering detail (retaining walls, etc.) shown on this plan is indicative only and subject to construction and relevant local authority approval.
- For further detail regarding services, facilities and features which may have relevance to the proposed lot, reference should be made to the Development Application approval conditions, the approved operational works drawings and current engineering drawings.

Contour Interval – 0.5 metre

—50.0—

Design Contours

Retaining Wall (Due to plotting limitations the retaining walls shown are not to scale and are indicative only)

HW 1.0

LW 0.2

AW 0.8

Height of Highest Point of Wall (Metres)

Height of Lowest Point of Wall (Metres)

Average Height of Wall (Metres)

Compaction of fill will be done in accordance with Australian Standard AS 3798–2007, under Level 1 inspection and testing by the nominated Geotechnical Inspection and Testing Authority.

x 0.1

Cut/Fill, calculated between design and existing surface contours

Area to be Cut, as supplied by RMA Engineers

Area to be Filled, as supplied by RMA Engineers

Lot levels and earthworks derived from Engineering Drawings.

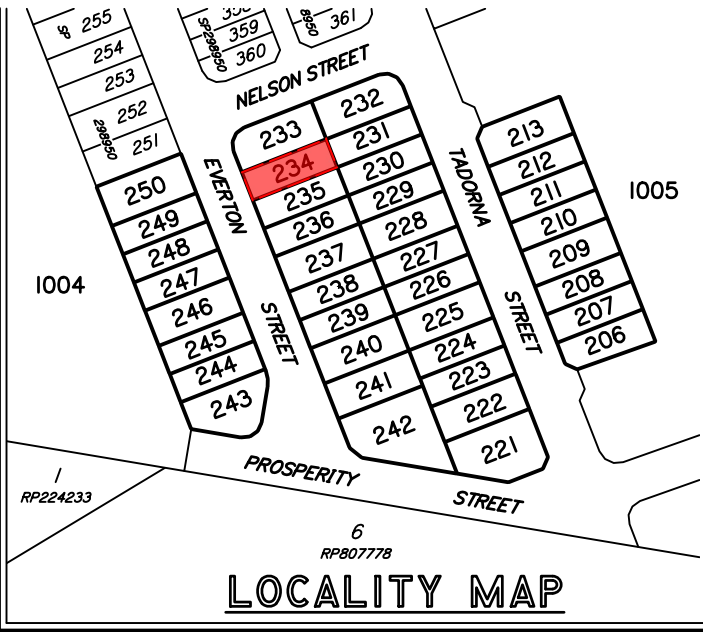
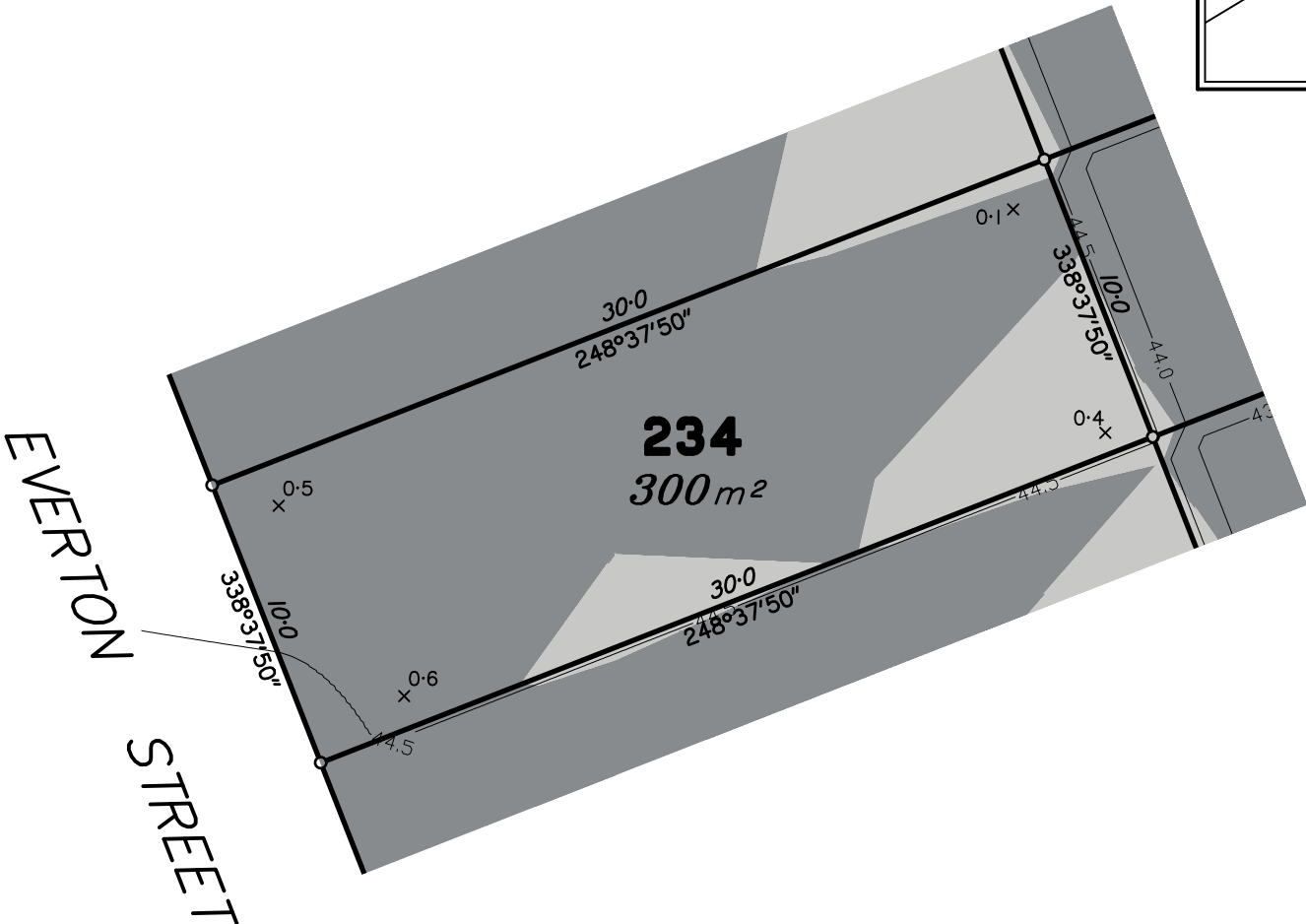

Scale 1:250 – Lengths are in Metres.

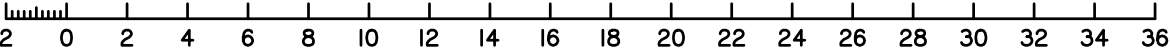

Meridian: MGA Zone 56 ☒ Yes ☐ No Contour Height Datum: AHD

dts

urban planning, surveying & development

Brisbane

Mackay

PO Box 3128, West End QLD 4101 PO Box 11711, Mackay Caneland QLD 4740

Ph: 07 3118 0600 Ph: 1300 278 783

brisbane@dtsqld.com.au mackay@dtsqld.com.au

B	UPDATE CIVIL DESIGN INFORMATION ORIGINAL ISSUE	21/07/20 15/01/20	AA AA	AV AV
A				
Issue	Details	Date	Drawn	Checked

DISCLOSURE PLAN  
DAHUA POINTCORP NARANGBA PTY LTD  
STAGE 8A "AMITY"  
CALLAGHAN ROAD, NARANGBA

Dwg No: A3–5928/234	Issue: B
Project: BNE150725	
File: B150725Dis8A.dwg	

DISCLOSURE PLAN  
PROPOSED LOT 235

This plan is to be read in conjunction with the disclosure statement prepared for this lot.

Cancelling part of Lot 1003 on SP298957 and  
Lots 1 & 2 on RP79384  
Locality of Narangba

- These notes form an integral part of this plan. No part of this plan may be reproduced without these notes being included.
- All dimensions and areas shown are subject to final survey and relevant local authority approval.
- This plan has been prepared for issue to a buyer as a disclosure plan under the Land Sales Act 1984. It is not to be used for any other purpose.
- Levels and contours shown on this plan are not to be used for building design or construction; a topographical survey of the site is required.
- Any engineering detail (retaining walls, etc.) shown on this plan is indicative only and subject to construction and relevant local authority approval.
- For further detail regarding services, facilities and features which may have relevance to the proposed lot, reference should be made to the Development Application approval conditions, the approved operational works drawings and current engineering drawings.

Contour Interval – 0.5 metre

—50.0—

Design Contours

Retaining Wall (Due to plotting limitations the retaining walls shown are not to scale and are indicative only)

HW 1.0

LW 0.2

AW 0.8

Height of Highest Point of Wall (Metres)

Height of Lowest Point of Wall (Metres)

Average Height of Wall (Metres)

Compaction of fill will be done in accordance with Australian Standard AS 3798–2007, under Level 1 inspection and testing by the nominated Geotechnical Inspection and Testing Authority.

x0.1

Cut/Fill, calculated between design and existing surface contours

Area to be Cut, as supplied by RMA Engineers

Area to be Filled, as supplied by RMA Engineers

Lot levels and earthworks derived from Engineering Drawings.

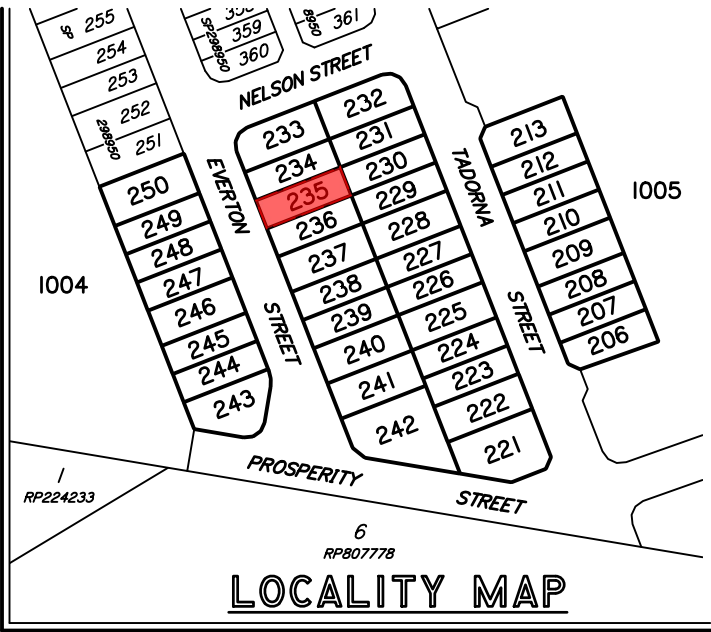
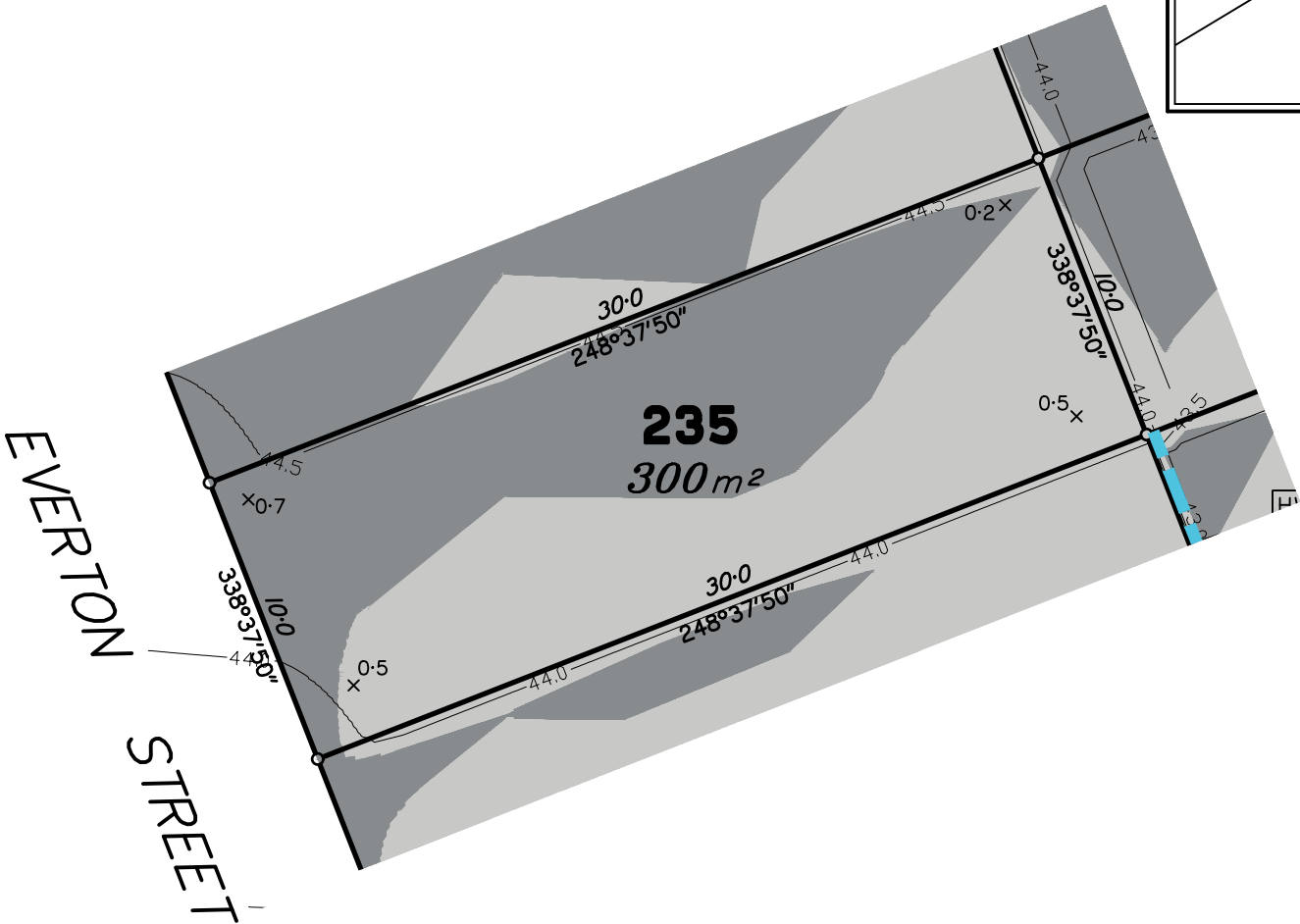

Scale 1:250 – Lengths are in Metres.

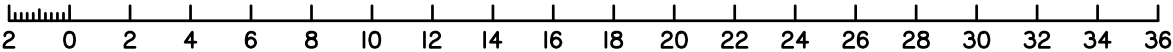

Meridian: MGA Zone 56 ☒ Yes ☐ No  
Contour Height Datum: AHD

dts

urban planning, surveying & development

Brisbane

Mackay

PO Box 3128, West End QLD 4101 PO Box 11711, Mackay Caneland QLD 4740  
Ph: 07 3118 0600 Ph: 1300 278 783  
brisbane@dtsqld.com.au mackay@dtsqld.com.au

B	UPDATE CIVIL DESIGN INFORMATION	21/07/20	AA	AV
A	ORIGINAL ISSUE	15/01/20	AA	AV
Issue	Details	Date	Drawn	Checked

DISCLOSURE PLAN  
DAHUA POINTCORP NARANGBA PTY LTD  
STAGE 8A "AMITY"  
CALLAGHAN ROAD, NARANGBA

Dwg No:	Issue:
A3–5928/235	B
Project:	
BNE150725	
File:	
B150725Dis8A.dwg	

DISCLOSURE PLAN  
PROPOSED LOT 236

This plan is to be read in conjunction with the disclosure statement prepared for this lot.

Cancelling part of Lot 1003 on SP298957 and Lots 1 & 2 on RP79384  
Locality of Narangba

- These notes form an integral part of this plan. No part of this plan may be reproduced without these notes being included.
- All dimensions and areas shown are subject to final survey and relevant local authority approval.
- This plan has been prepared for issue to a buyer as a disclosure plan under the Land Sales Act 1984. It is not to be used for any other purpose.
- Levels and contours shown on this plan are not to be used for building design or construction; a topographical survey of the site is required.
- Any engineering detail (retaining walls, etc.) shown on this plan is indicative only and subject to construction and relevant local authority approval.
- For further detail regarding services, facilities and features which may have relevance to the proposed lot, reference should be made to the Development Application approval conditions, the approved operational works drawings and current engineering drawings.

Contour Interval – 0.5 metre

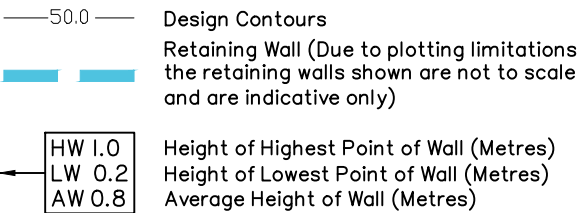

Compaction of fill will be done in accordance with Australian Standard AS 3798–2007, under Level 1 inspection and testing by the nominated Geotechnical Inspection and Testing Authority.

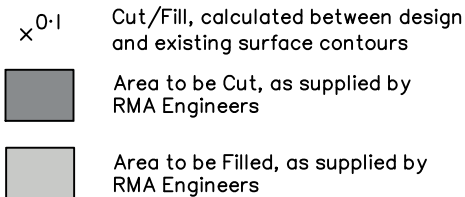

Lot levels and earthworks derived from Engineering Drawings.

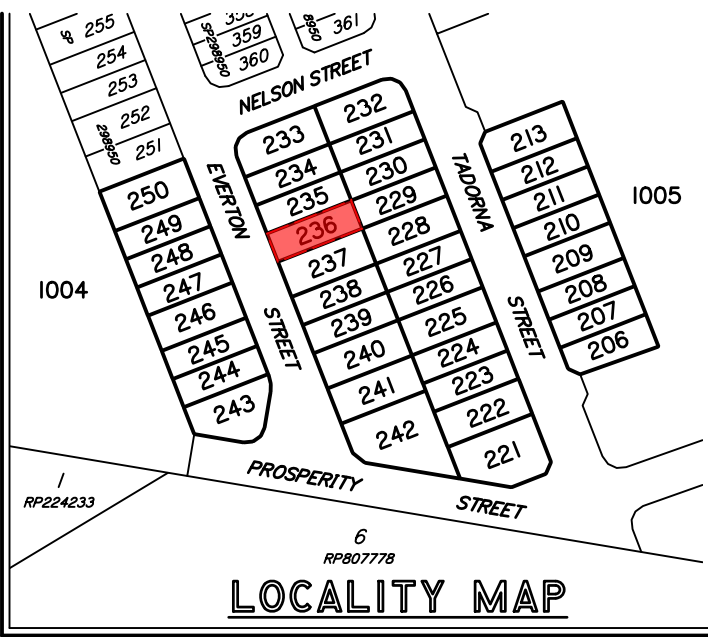
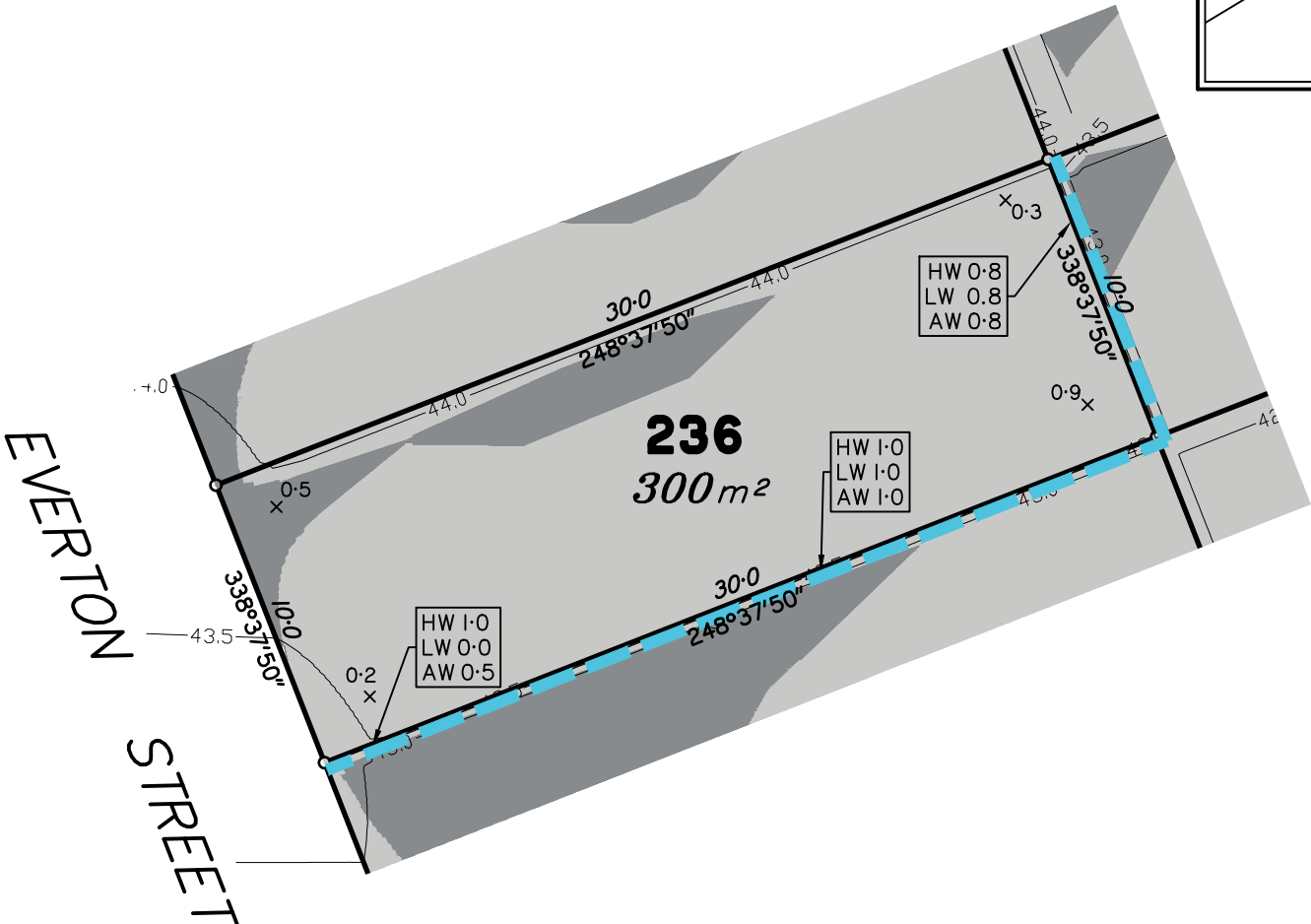

Scale 1:250 – Lengths are in Metres.

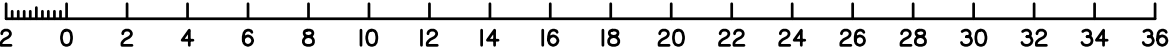

Meridian: MGA Zone 56 ☒ Yes ☐ No  
Contour Height Datum: AHD

B A	UPDATE CIVIL DESIGN INFORMATION ORIGINAL ISSUE	21/07/20 15/01/20	AA AA	AV AV	DISCLOSURE PLAN DAHUA POINTCORP NARANGBA PTY LTD STAGE 8A "AMITY" CALLAGHAN ROAD, NARANGBA	Dwg No: A3–5928/236	Issue: B
						Project: BNE150725	File: B150725Dis8A.dwg
Issue	Details	Date	Drawn	Checked			



DISCLOSURE PLAN  
PROPOSED LOT 237

This plan is to be read in conjunction with the disclosure statement prepared for this lot.

Cancelling part of Lot 1003 on SP298957 and Lots 1 & 2 on RP79384  
Locality of Narangba

- These notes form an integral part of this plan. No part of this plan may be reproduced without these notes being included.
- All dimensions and areas shown are subject to final survey and relevant local authority approval.
- This plan has been prepared for issue to a buyer as a disclosure plan under the Land Sales Act 1984. It is not to be used for any other purpose.
- Levels and contours shown on this plan are not to be used for building design or construction; a topographical survey of the site is required.
- Any engineering detail (retaining walls, etc.) shown on this plan is indicative only and subject to construction and relevant local authority approval.
- For further detail regarding services, facilities and features which may have relevance to the proposed lot, reference should be made to the Development Application approval conditions, the approved operational works drawings and current engineering drawings.

Contour Interval – 0.5 metre

—50.0—

Design Contours

Retaining Wall (Due to plotting limitations the retaining walls shown are not to scale and are indicative only)

HW 1.0

LW 0.2

AW 0.8

Height of Highest Point of Wall (Metres)  
Height of Lowest Point of Wall (Metres)  
Average Height of Wall (Metres)

Compaction of fill will be done in accordance with Australian Standard AS 3798–2007, under Level 1 inspection and testing by the nominated Geotechnical Inspection and Testing Authority.

x 0.1

Cut/Fill, calculated between design and existing surface contours

Area to be Cut, as supplied by RMA Engineers

Area to be Filled, as supplied by RMA Engineers

Lot levels and earthworks derived from Engineering Drawings.

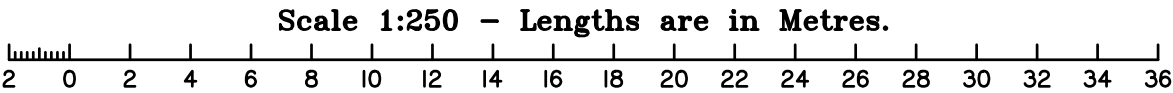
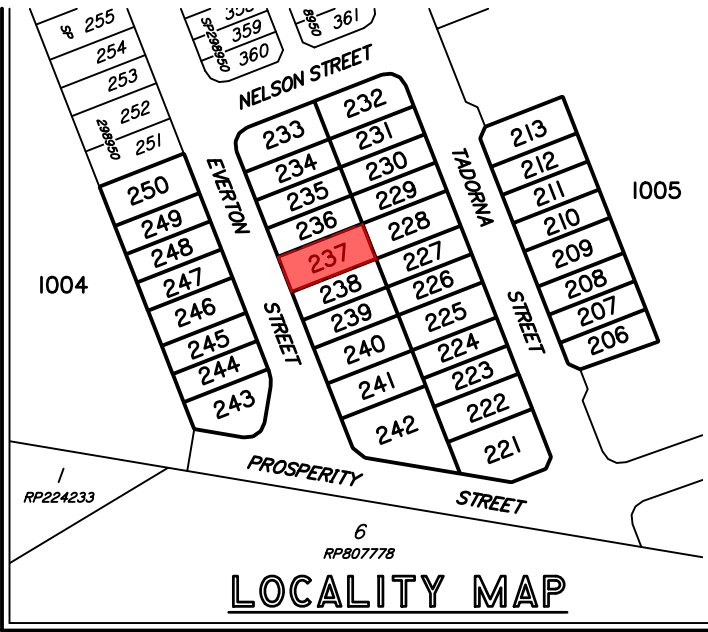
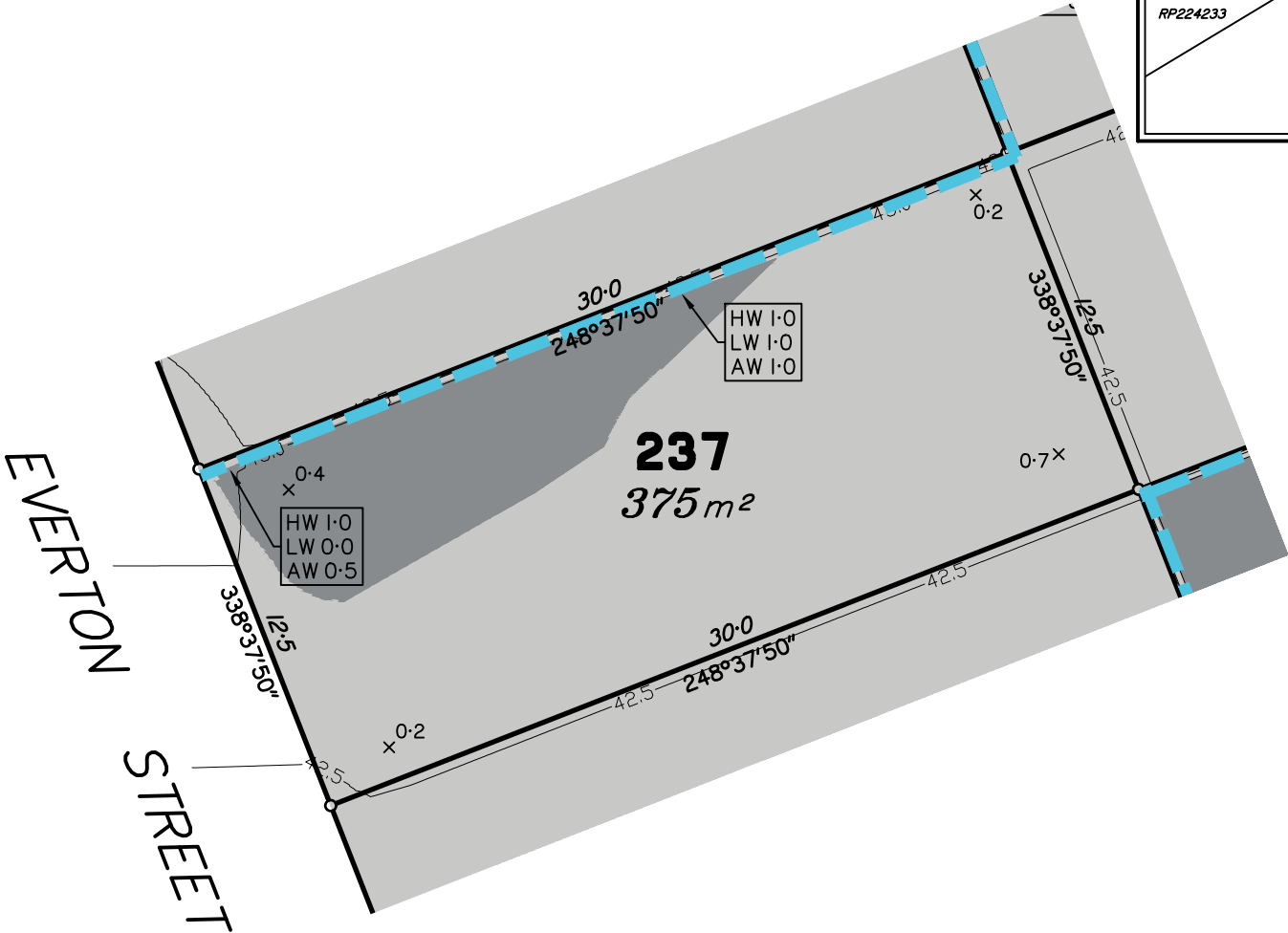

Meridian: MGA Zone 56 ☒ Yes ☐ No  
Contour Height Datum: AHD

dts

urban planning, surveying & development

Brisbane

Mackay

PO Box 3128, West End QLD 4101 PO Box 11711, Mackay Caneland QLD 4740  
Ph: 07 3118 0600 Ph: 1300 278 783  
brisbane@dtsqld.com.au mackay@dtsqld.com.au

B	UPDATE CIVIL DESIGN INFORMATION	21/07/20	AA	AV
A	ORIGINAL ISSUE	15/01/20	AA	AV
Issue	Details	Date	Drawn	Checked

DISCLOSURE PLAN  
DAHUA POINTCORP NARANGBA PTY LTD  
STAGE 8A "AMITY"  
CALLAGHAN ROAD, NARANGBA

Dwg No:	Issue:
A3–5928/237	B
Project:	
BNE150725	
File:	
B150725Dis8A.dwg	

DISCLOSURE PLAN  
PROPOSED LOT 238

This plan is to be read in conjunction with the disclosure statement prepared for this lot.

Cancelling part of Lot 1003 on SP298957 and  
Lots 1 & 2 on RP79384  
Locality of Narangba

- These notes form an integral part of this plan. No part of this plan may be reproduced without these notes being included.
- All dimensions and areas shown are subject to final survey and relevant local authority approval.
- This plan has been prepared for issue to a buyer as a disclosure plan under the Land Sales Act 1984. It is not to be used for any other purpose.
- Levels and contours shown on this plan are not to be used for building design or construction; a topographical survey of the site is required.
- Any engineering detail (retaining walls, etc.) shown on this plan is indicative only and subject to construction and relevant local authority approval.
- For further detail regarding services, facilities and features which may have relevance to the proposed lot, reference should be made to the Development Application approval conditions, the approved operational works drawings and current engineering drawings.

Contour Interval – 0.5 metre

—50.0—

Design Contours

Retaining Wall (Due to plotting limitations the retaining walls shown are not to scale and are indicative only)

HW 1.0

LW 0.2

AW 0.8

Height of Highest Point of Wall (Metres)

Height of Lowest Point of Wall (Metres)

Average Height of Wall (Metres)

Compaction of fill will be done in accordance with Australian Standard AS 3798–2007, under Level 1 inspection and testing by the nominated Geotechnical Inspection and Testing Authority.

x 0.1

Cut/Fill, calculated between design and existing surface contours

Area to be Cut, as supplied by RMA Engineers

Area to be Filled, as supplied by RMA Engineers

Lot levels and earthworks derived from Engineering Drawings.

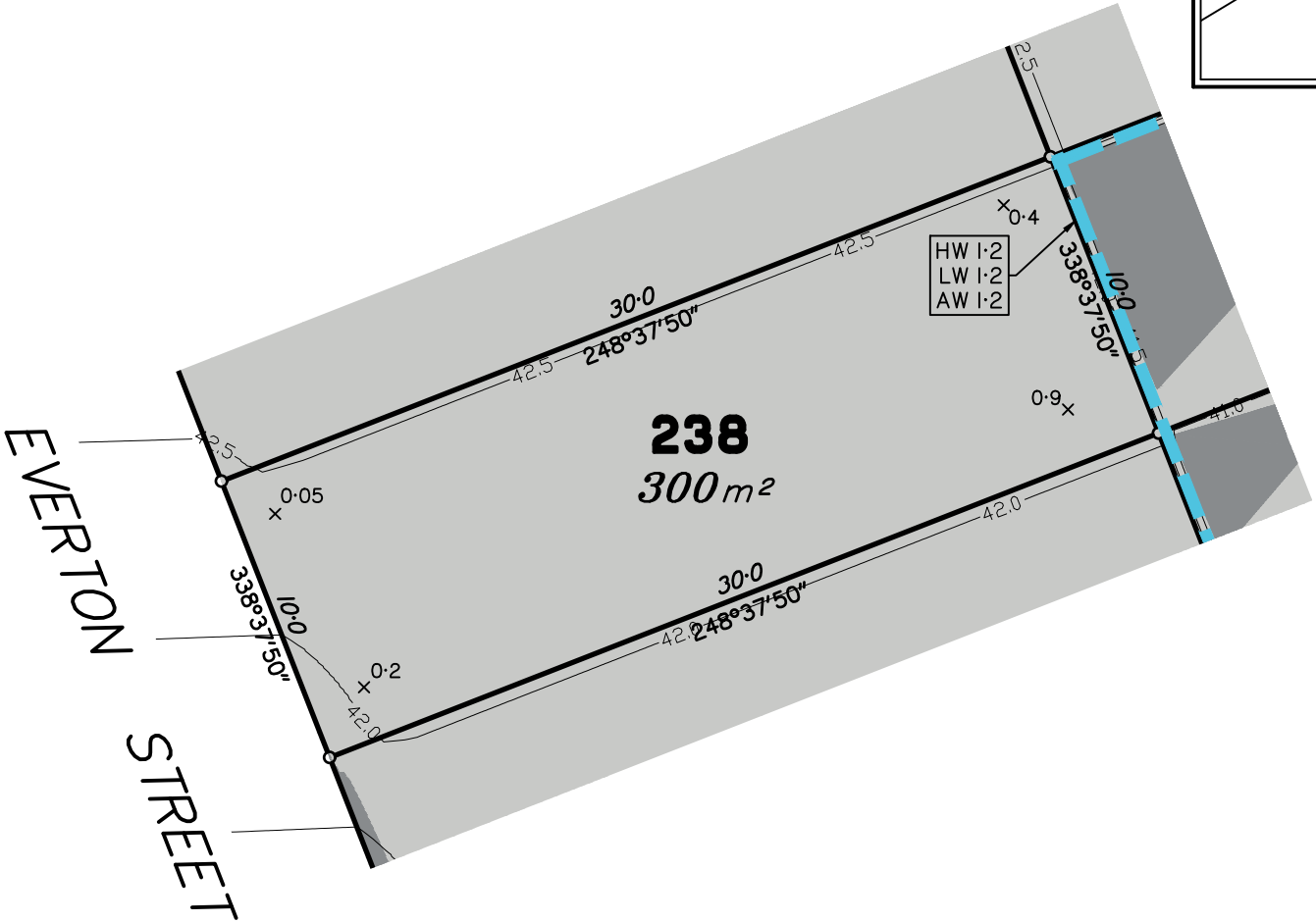
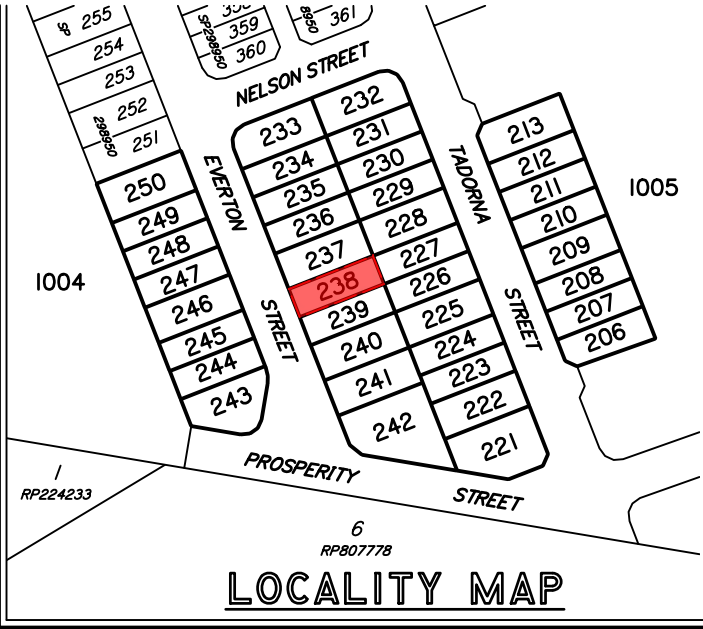

Scale 1:250 – Lengths are in Metres.

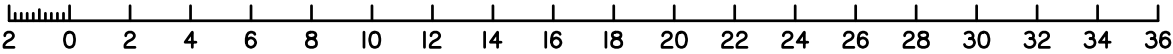

Meridian: MGA Zone 56 ☒ Yes ☐ No  
Contour Height Datum: AHD

dts

urban planning, surveying & development

Brisbane

Mackay

PO Box 3128, West End QLD 4101 PO Box 11711, Mackay Caneland QLD 4740

Ph: 07 3118 0600 Ph: 1300 278 783

brisbane@dtsqld.com.au mackay@dtsqld.com.au

B A	UPDATE CIVIL DESIGN INFORMATION ORIGINAL ISSUE	21/07/20 15/01/20	AA AA	AV AV	DISCLOSURE PLAN DAHUA POINTCORP NARANGBA PTY LTD STAGE 8A "AMITY" CALLAGHAN ROAD, NARANGBA	Dwg No: A3–5928/238	Issue: B
						Project: BNE150725	File: B150725Dis8A.dwg
Issue	Details	Date	Drawn	Checked			

DISCLOSURE PLAN  
PROPOSED LOT 239

This plan is to be read in conjunction with the disclosure statement prepared for this lot.

Cancelling part of Lot 1003 on SP298957 and  
Lots 1 & 2 on RP79384  
Locality of Narangba

- These notes form an integral part of this plan. No part of this plan may be reproduced without these notes being included.
- All dimensions and areas shown are subject to final survey and relevant local authority approval.
- This plan has been prepared for issue to a buyer as a disclosure plan under the Land Sales Act 1984. It is not to be used for any other purpose.
- Levels and contours shown on this plan are not to be used for building design or construction; a topographical survey of the site is required.
- Any engineering detail (retaining walls, etc.) shown on this plan is indicative only and subject to construction and relevant local authority approval.
- For further detail regarding services, facilities and features which may have relevance to the proposed lot, reference should be made to the Development Application approval conditions, the approved operational works drawings and current engineering drawings.

Contour Interval – 0.5 metre

- 50.0— Design Contours
- Retaining Wall (Due to plotting limitations the retaining walls shown are not to scale and are indicative only)
- HW 1.0  
LW 0.2  
AW 0.8
- Height of Highest Point of Wall (Metres)  
Height of Lowest Point of Wall (Metres)  
Average Height of Wall (Metres)

Compaction of fill will be done in accordance with Australian Standard AS 3798–2007, under Level 1 inspection and testing by the nominated Geotechnical Inspection and Testing Authority.

- x 0.1 Cut/Fill, calculated between design and existing surface contours
- Area to be Cut, as supplied by RMA Engineers
- Area to be Filled, as supplied by RMA Engineers

Lot levels and earthworks derived from Engineering Drawings.

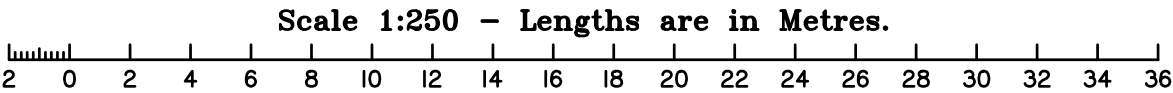
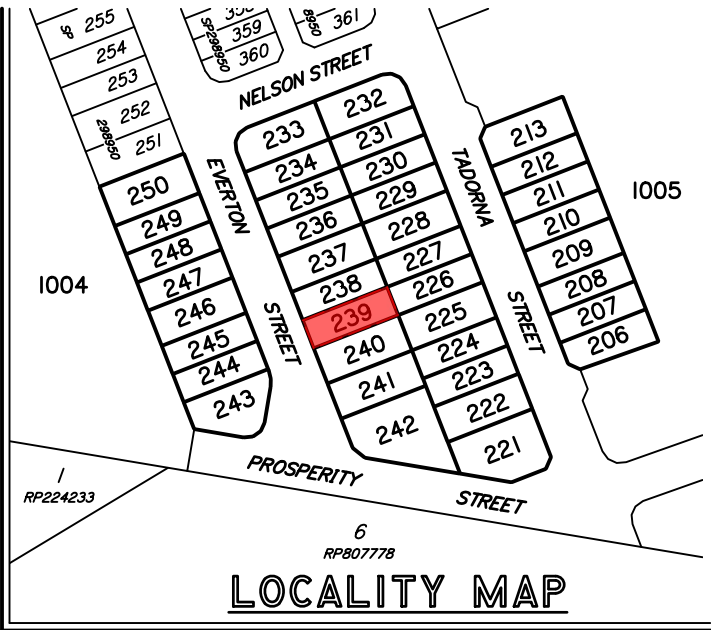
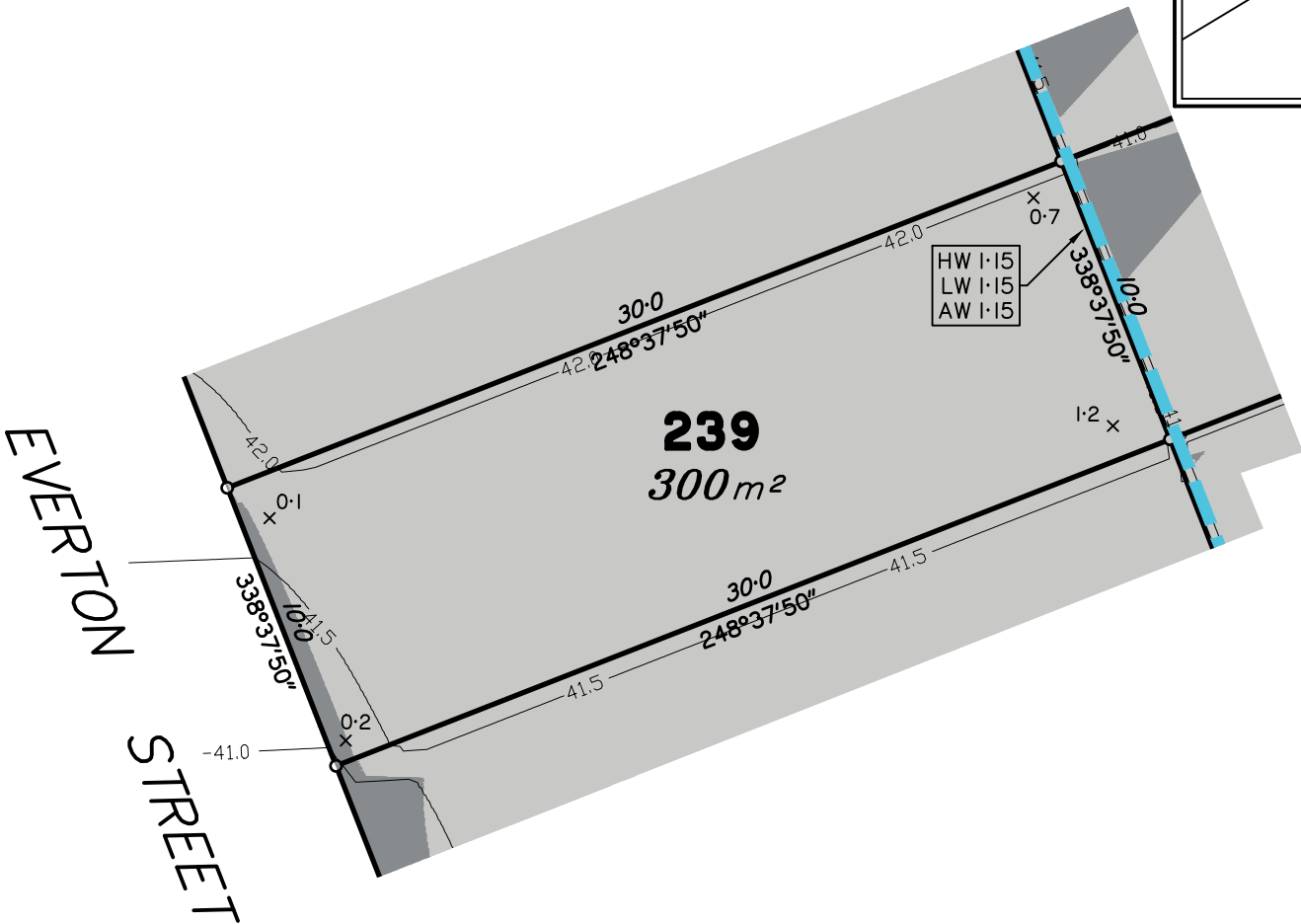

Meridian: MGA Zone 56 ☒ Yes ☐ No  
Contour Height Datum: AHD

B	UPDATE CIVIL DESIGN INFORMATION	21/07/20	AA	AV
A	ORIGINAL ISSUE	15/01/20	AA	AV
Issue	Details	Date	Drawn	Checked

DISCLOSURE PLAN  
DAHUA POINTCORP NARANGBA PTY LTD  
STAGE 8A "AMITY"  
CALLAGHAN ROAD, NARANGBA

Dwg No:	Issue:
A3-5928/239	B
Project:	
BNE150725	
File:	
B150725Dis8A.dwg	

DISCLOSURE PLAN  
PROPOSED LOT 240

This plan is to be read in conjunction with the disclosure statement prepared for this lot.

Cancelling part of Lot 1003 on SP298957 and Lots 1 & 2 on RP79384  
Locality of Narangba

- These notes form an integral part of this plan. No part of this plan may be reproduced without these notes being included.
- All dimensions and areas shown are subject to final survey and relevant local authority approval.
- This plan has been prepared for issue to a buyer as a disclosure plan under the Land Sales Act 1984. It is not to be used for any other purpose.
- Levels and contours shown on this plan are not to be used for building design or construction; a topographical survey of the site is required.
- Any engineering detail (retaining walls, etc.) shown on this plan is indicative only and subject to construction and relevant local authority approval.
- For further detail regarding services, facilities and features which may have relevance to the proposed lot, reference should be made to the Development Application approval conditions, the approved operational works drawings and current engineering drawings.

Contour Interval – 0.5 metre

- 50.0— Design Contours
- Retaining Wall (Due to plotting limitations the retaining walls shown are not to scale and are indicative only)
- HW 1.0  
LW 0.2  
AW 0.8
- Height of Highest Point of Wall (Metres)  
Height of Lowest Point of Wall (Metres)  
Average Height of Wall (Metres)

Compaction of fill will be done in accordance with Australian Standard AS 3798–2007, under Level 1 inspection and testing by the nominated Geotechnical Inspection and Testing Authority.

- x 0.1 Cut/Fill, calculated between design and existing surface contours
- Area to be Cut, as supplied by RMA Engineers
- Area to be Filled, as supplied by RMA Engineers

Lot levels and earthworks derived from Engineering Drawings.

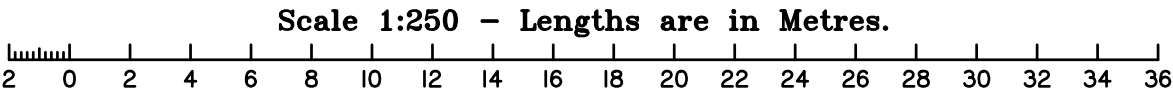
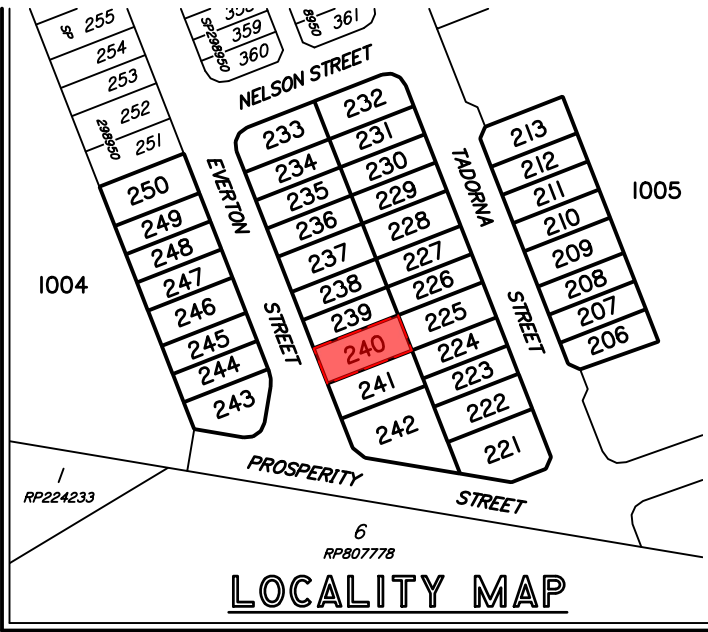
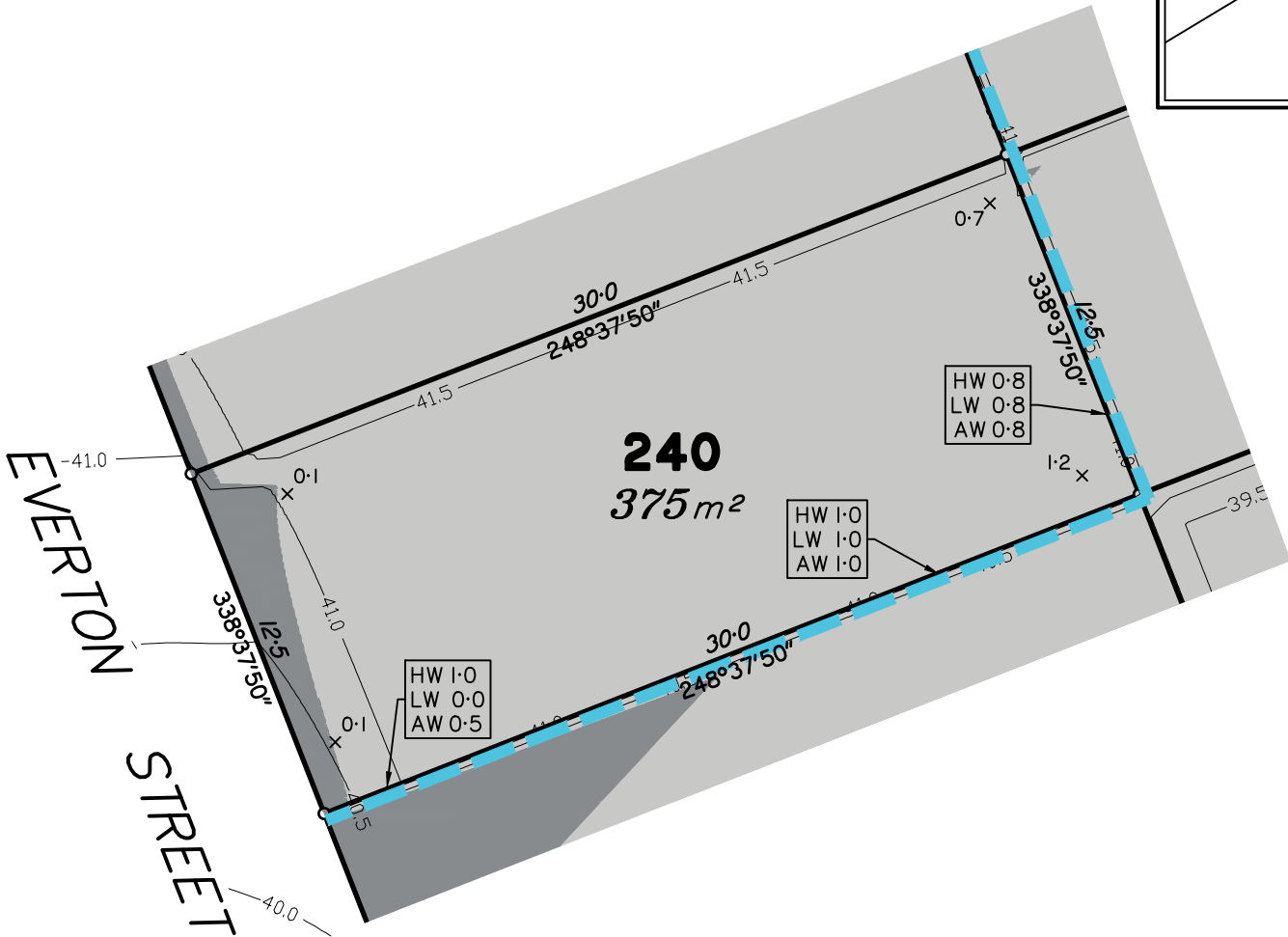

Meridian: MGA Zone 56 ☒ Yes ☐ No  
Contour Height Datum: AHD

B A	UPDATE CIVIL DESIGN INFORMATION ORIGINAL ISSUE	21/07/20 15/01/20	AA AA	AV AV
Issue	Details	Date	Drawn	Checked

DISCLOSURE PLAN  
DAHUA POINTCORP NARANGBA PTY LTD  
STAGE 8A "AMITY"  
CALLAGHAN ROAD, NARANGBA

Dwg No: A3–5928/240	Issue: B
Project: BNE150725	
File: B150725Dis8A.dwg	



DISCLOSURE PLAN  
PROPOSED LOT 241

This plan is to be read in conjunction with the disclosure statement prepared for this lot.

Cancelling part of Lot 1003 on SP298957 and  
Lots 1 & 2 on RP79384  
Locality of Narangba

1. These notes form an integral part of this plan. No part of this plan may be reproduced without these notes being included.
2. All dimensions and areas shown are subject to final survey and relevant local authority approval.
3. This plan has been prepared for issue to a buyer as a disclosure plan under the Land Sales Act 1984. It is not to be used for any other purpose.
4. Levels and contours shown on this plan are not to be used for building design or construction; a topographical survey of the site is required.
5. Any engineering detail (retaining walls, etc.) shown on this plan is indicative only and subject to construction and relevant local authority approval.
6. For further detail regarding services, facilities and features which may have relevance to the proposed lot, reference should be made to the Development Application approval conditions, the approved operational works drawings and current engineering drawings.

Contour Interval – 0.5 metre

—50.0—

Design Contours

Retaining Wall (Due to plotting limitations the retaining walls shown are not to scale and are indicative only)

HW 1.0  
LW 0.2  
AW 0.8

Height of Highest Point of Wall (Metres)  
Height of Lowest Point of Wall (Metres)  
Average Height of Wall (Metres)

Compaction of fill will be done in accordance with Australian Standard AS 3798–2007, under Level 1 inspection and testing by the nominated Geotechnical Inspection and Testing Authority.

x 0.1

Cut/Fill, calculated between design and existing surface contours

Area to be Cut, as supplied by RMA Engineers

Area to be Filled, as supplied by RMA Engineers

Lot levels and earthworks derived from Engineering Drawings.

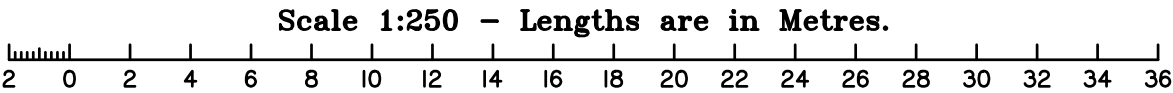
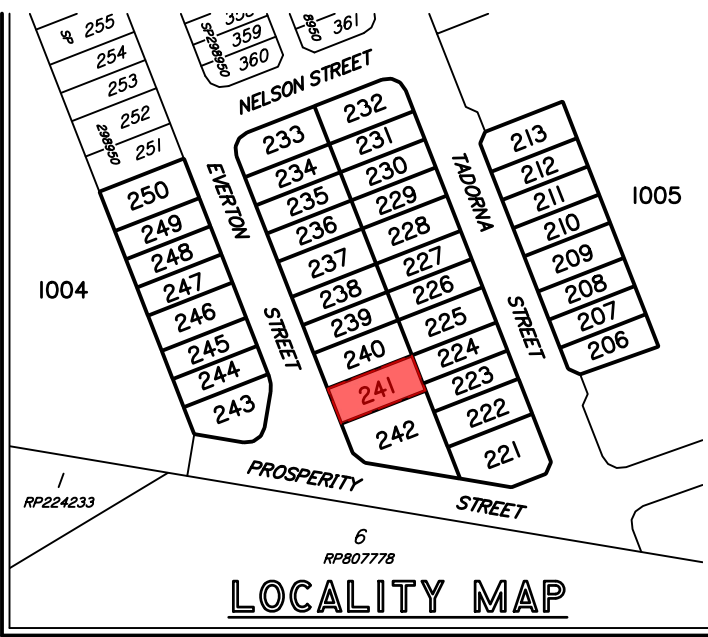
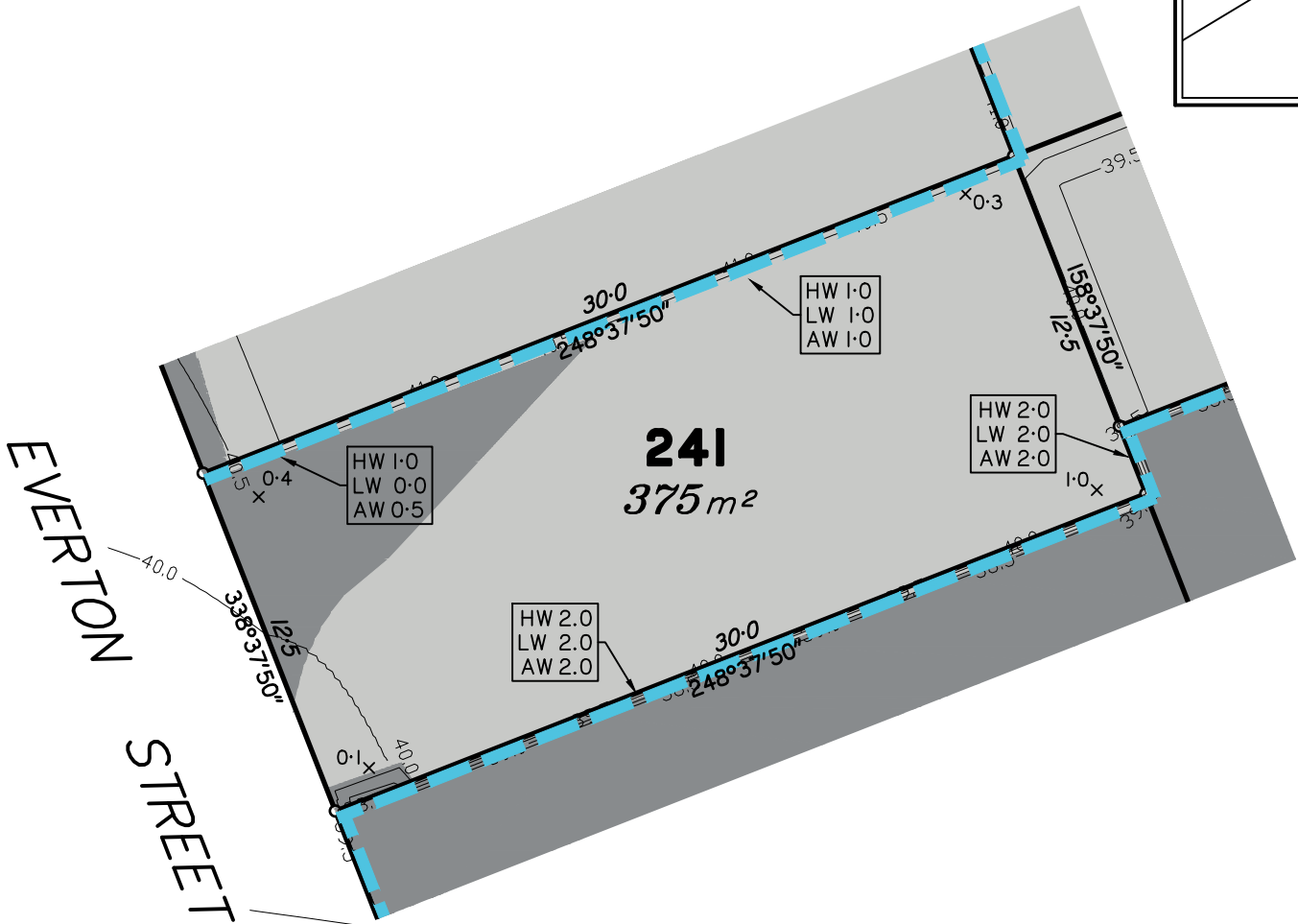

Meridian: MGA Zone 56 ☒ Yes ☐ No Contour Height Datum: AHD

dts

urban planning, surveying  
& development

Brisbane

Mackay

PO Box 3128, West End QLD 4101  
Ph: 07 3118 0600  
brisbane@dtsqld.com.au

PO Box 11711, Mackay Caneland QLD 4740  
Ph: 1300 278 783  
mackay@dtsqld.com.au

B	UPDATE CIVIL DESIGN INFORMATION ORIGINAL ISSUE	21/07/20 15/01/20	AA AA	AV AV
A				
Issue	Details	Date	Drawn	Checked

DISCLOSURE PLAN  
DAHUA POINTCORP NARANGBA PTY LTD  
STAGE 8A "AMITY"  
CALLAGHAN ROAD, NARANGBA

Dwg No: A3-5928/241	Issue: B
Project: BNE150725	
File: B150725Dis8A.dwg	

DISCLOSURE PLAN  
PROPOSED LOT 242

This plan is to be read in conjunction with the disclosure statement prepared for this lot.

Cancelling part of Lot 1003 on SP298957 and  
Lots 1 & 2 on RP79384  
Locality of Narangba

- These notes form an integral part of this plan. No part of this plan may be reproduced without these notes being included.
- All dimensions and areas shown are subject to final survey and relevant local authority approval.
- This plan has been prepared for issue to a buyer as a disclosure plan under the Land Sales Act 1984. It is not to be used for any other purpose.
- Levels and contours shown on this plan are not to be used for building design or construction; a topographical survey of the site is required.
- Any engineering detail (retaining walls, etc.) shown on this plan is indicative only and subject to construction and relevant local authority approval.
- For further detail regarding services, facilities and features which may have relevance to the proposed lot, reference should be made to the Development Application approval conditions, the approved operational works drawings and current engineering drawings.

Contour Interval – 0.5 metre

- 50.0— Design Contours
- Retaining Wall (Due to plotting limitations the retaining walls shown are not to scale and are indicative only)
- HW 1.0  
LW 0.2  
AW 0.8
- Height of Highest Point of Wall (Metres)  
Height of Lowest Point of Wall (Metres)  
Average Height of Wall (Metres)

Compaction of fill will be done in accordance with Australian Standard AS 3798–2007, under Level 1 inspection and testing by the nominated Geotechnical Inspection and Testing Authority.

- x0.1 Cut/Fill, calculated between design and existing surface contours
- Area to be Cut, as supplied by RMA Engineers
- Area to be Filled, as supplied by RMA Engineers

Lot levels and earthworks derived from Engineering Drawings.

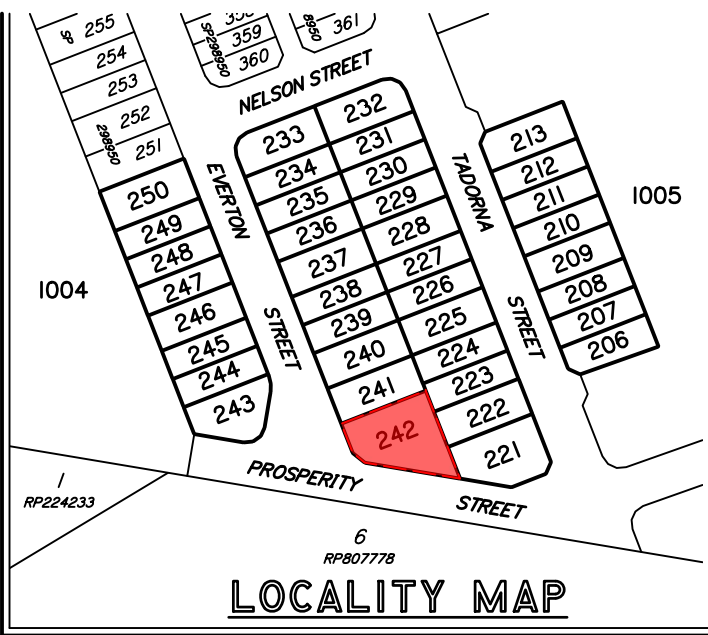
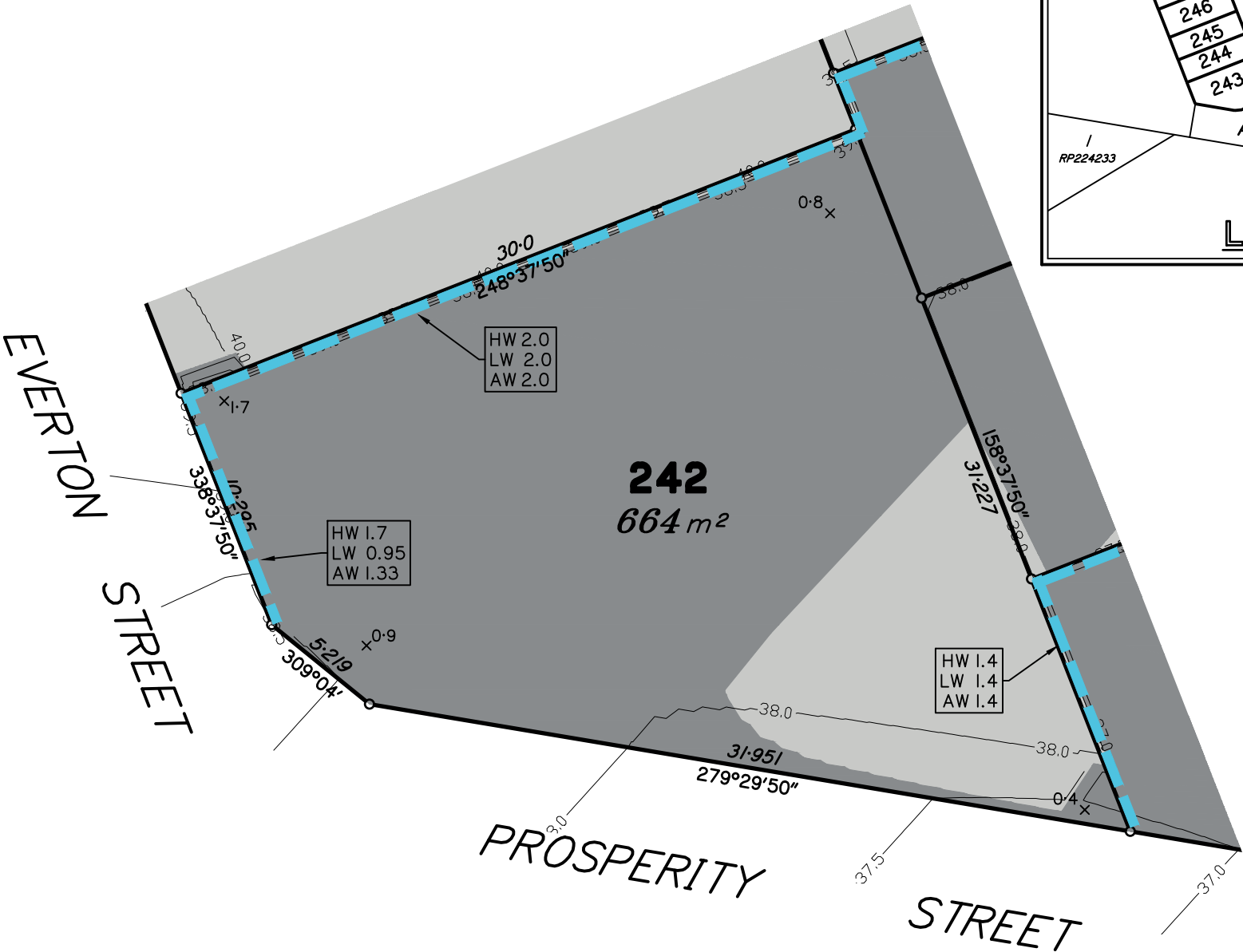

Scale 1:250 – Lengths are in Metres.

2 0 2 4 6 8 10 12 14 16 18 20 22 24 26 28 30 32 34 36

Meridian: MGA Zone 56 ☒ Yes ☐ No  
Contour Height Datum: AHD

B A	UPDATE CIVIL DESIGN INFORMATION ORIGINAL ISSUE	21/07/20 15/01/20	AA AA	AV AV
Issue	Details	Date	Drawn	Checked

DISCLOSURE PLAN  
DAHUA POINTCORP NARANGBA PTY LTD  
STAGE 8A "AMITY"  
CALLAGHAN ROAD, NARANGBA

Dwg No: A3–5928/242	Issue: B
Project: BNE150725	
File: B150725Dis8A.dwg	

DISCLOSURE PLAN  
PROPOSED LOT 243

This plan is to be read in conjunction with the disclosure statement prepared for this lot.

Cancelling part of Lot 1003 on SP298957 and  
Lots 1 & 2 on RP79384  
Locality of Narangba

- These notes form an integral part of this plan. No part of this plan may be reproduced without these notes being included.
- All dimensions and areas shown are subject to final survey and relevant local authority approval.
- This plan has been prepared for issue to a buyer as a disclosure plan under the Land Sales Act 1984. It is not to be used for any other purpose.
- Levels and contours shown on this plan are not to be used for building design or construction; a topographical survey of the site is required.
- Any engineering detail (retaining walls, etc.) shown on this plan is indicative only and subject to construction and relevant local authority approval.
- For further detail regarding services, facilities and features which may have relevance to the proposed lot, reference should be made to the Development Application approval conditions, the approved operational works drawings and current engineering drawings.

Contour Interval – 0.5 metre

- 50.0— Design Contours
- Retaining Wall (Due to plotting limitations the retaining walls shown are not to scale and are indicative only)
- HW 1.0  
LW 0.2  
AW 0.8
- Height of Highest Point of Wall (Metres)  
Height of Lowest Point of Wall (Metres)  
Average Height of Wall (Metres)

Compaction of fill will be done in accordance with Australian Standard AS 3798–2007, under Level 1 inspection and testing by the nominated Geotechnical Inspection and Testing Authority.

- x 0.1 Cut/Fill, calculated between design and existing surface contours
- Area to be Cut, as supplied by RMA Engineers
- Area to be Filled, as supplied by RMA Engineers

Lot levels and earthworks derived from Engineering Drawings.

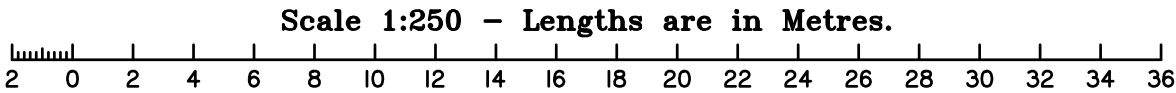
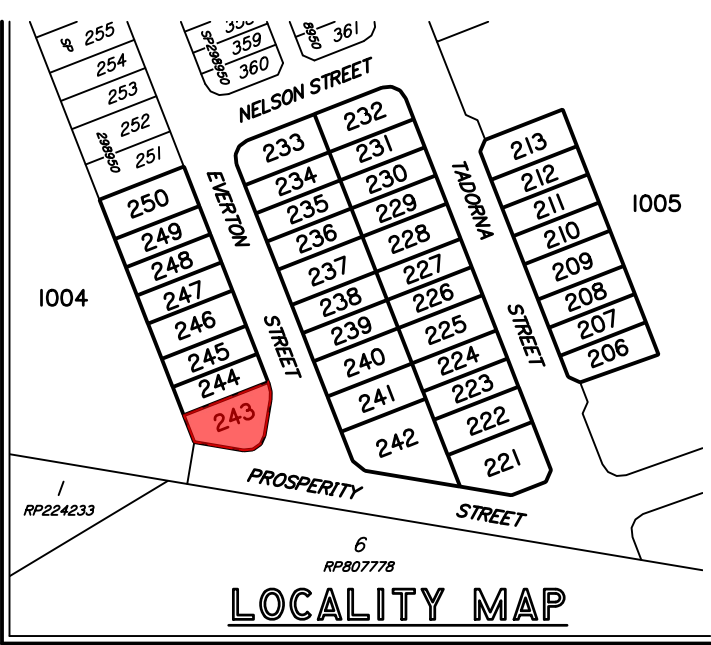
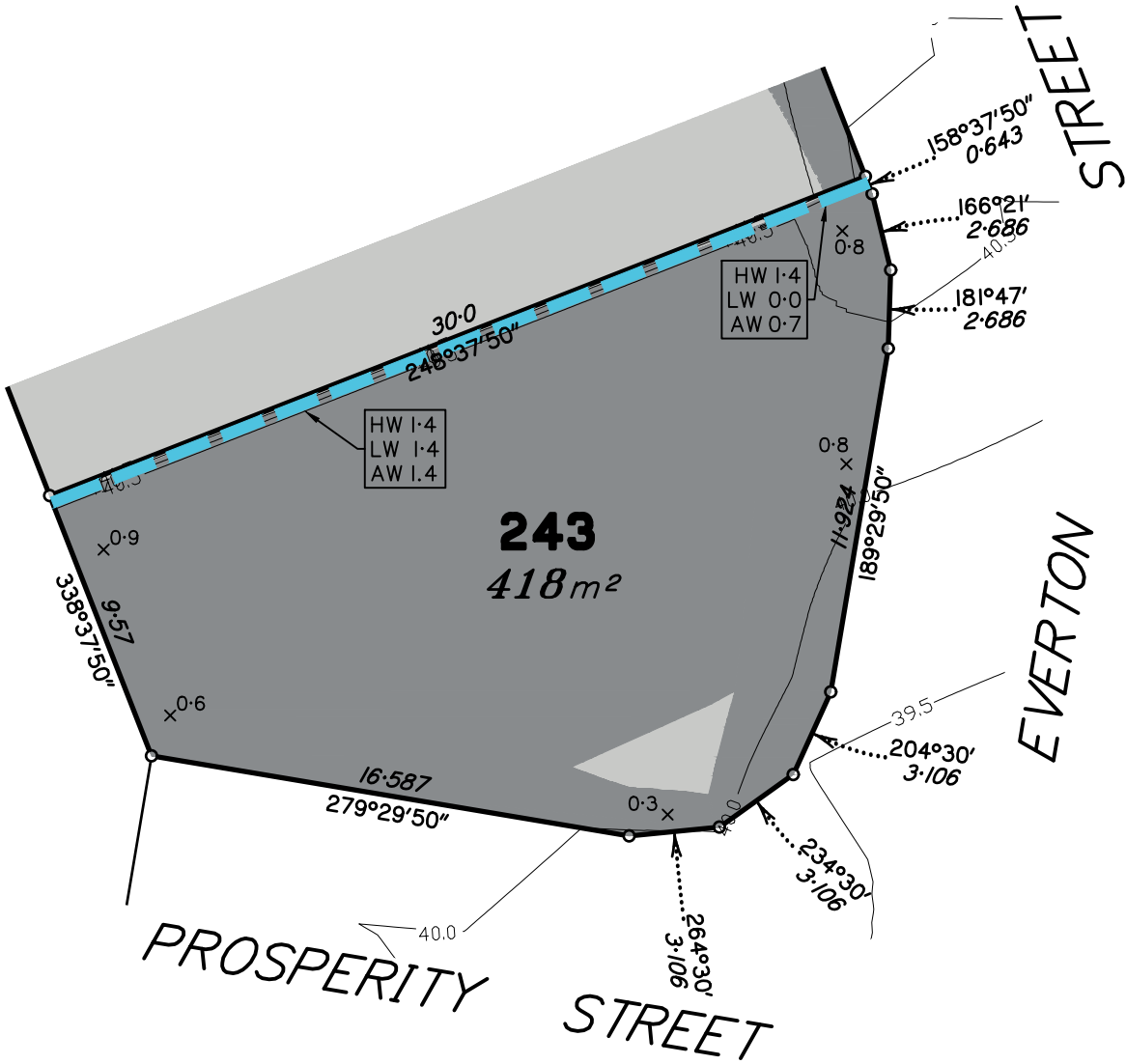

Meridian: MGA Zone 56 ☒ Yes ☐ No  
Contour Height Datum: AHD

B A	UPDATE CIVIL DESIGN INFORMATION ORIGINAL ISSUE	21/07/20 15/01/20	AA AA	AV AV	DISCLOSURE PLAN DAHUA POINTCORP NARANGBA PTY LTD STAGE 8A "AMITY" CALLAGHAN ROAD, NARANGBA	Dwg No: A3–5928/243	Issue: B
						Project: BNE150725	File: B150725Dis8A.dwg
Issue	Details	Date	Drawn	Checked			

DISCLOSURE PLAN  
PROPOSED LOT 244

This plan is to be read in conjunction with the disclosure statement prepared for this lot.

Cancelling part of Lot 1003 on SP298957 and  
Lots 1 & 2 on RP79384  
Locality of Narangba

1. These notes form an integral part of this plan. No part of this plan may be reproduced without these notes being included.
2. All dimensions and areas shown are subject to final survey and relevant local authority approval.
3. This plan has been prepared for issue to a buyer as a disclosure plan under the Land Sales Act 1984. It is not to be used for any other purpose.
4. Levels and contours shown on this plan are not to be used for building design or construction; a topographical survey of the site is required.
5. Any engineering detail (retaining walls, etc.) shown on this plan is indicative only and subject to construction and relevant local authority approval.
6. For further detail regarding services, facilities and features which may have relevance to the proposed lot, reference should be made to the Development Application approval conditions, the approved operational works drawings and current engineering drawings.

Contour Interval – 0.5 metre

—50.0—

Design Contours

Retaining Wall (Due to plotting limitations the retaining walls shown are not to scale and are indicative only)

HW 1.0

LW 0.2

AW 0.8

Height of Highest Point of Wall (Metres)

Height of Lowest Point of Wall (Metres)

Average Height of Wall (Metres)

Compaction of fill will be done in accordance with Australian Standard AS 3798–2007, under Level 1 inspection and testing by the nominated Geotechnical Inspection and Testing Authority.

x 0.1

Cut/Fill, calculated between design and existing surface contours

Area to be Cut, as supplied by RMA Engineers

Area to be Filled, as supplied by RMA Engineers

Lot levels and earthworks derived from Engineering Drawings.

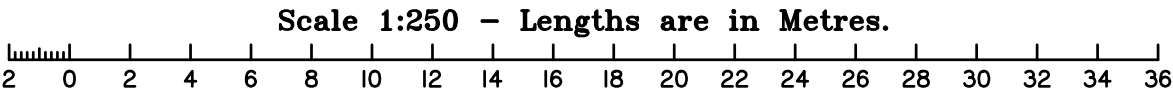
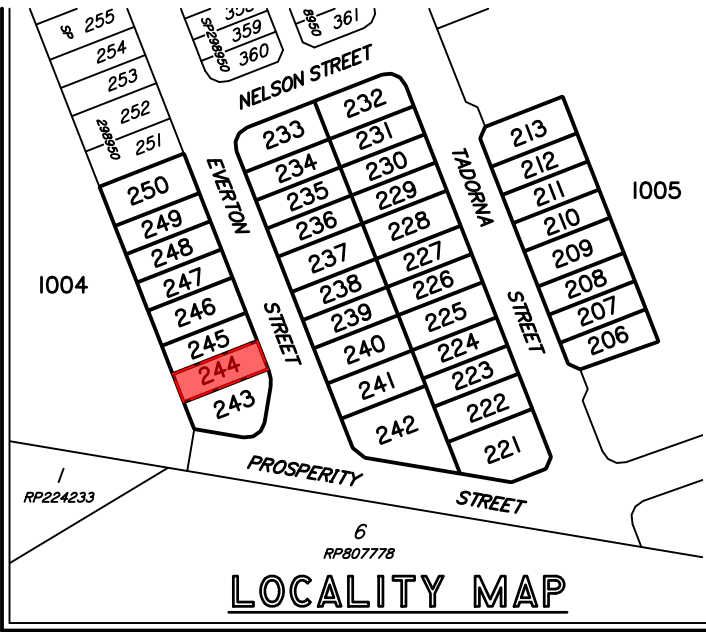
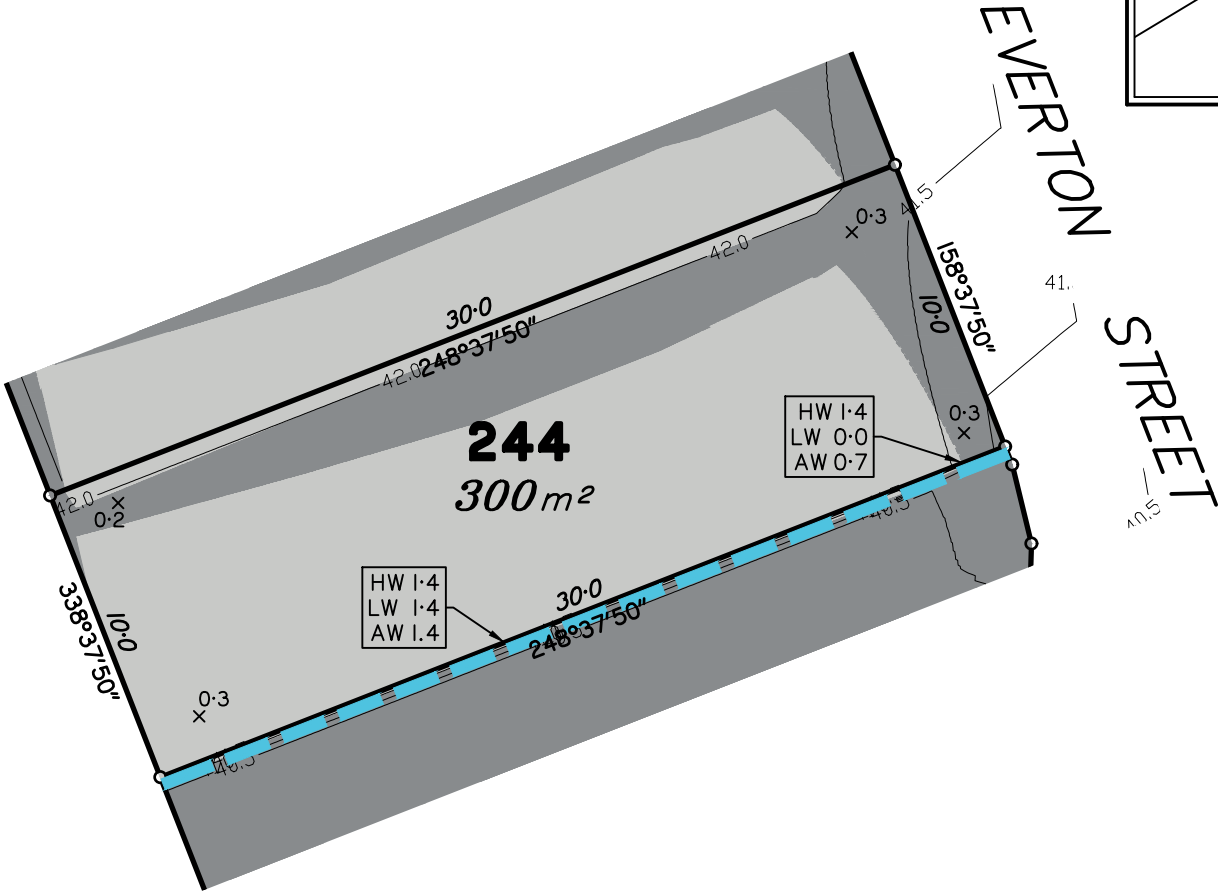

Meridian: MGA Zone 56 ☒ Yes ☐ No Contour Height Datum: AHD

Urban planning, surveying & development

Brisbane

Mackay

PO Box 3128, West End QLD 4101  
Ph: 07 3118 0600  
brisbane@dtsqld.com.au

PO Box 11711, Mackay Caneland QLD 4740  
Ph: 1300 278 783  
mackay@dtsqld.com.au

B A	UPDATE CIVIL DESIGN INFORMATION ORIGINAL ISSUE	21/07/20 15/01/20	AA AA	AV AV
Issue	Details	Date	Drawn	Checked

DISCLOSURE PLAN  
DAHUA POINTCORP NARANGBA PTY LTD  
STAGE 8A "AMITY"  
CALLAGHAN ROAD, NARANGBA

Dwg No: A3–5928/244	Issue: B
Project: BNE150725	
File: B150725Dis8A.dwg	



DISCLOSURE PLAN  
PROPOSED LOT 245

This plan is to be read in conjunction with the disclosure statement prepared for this lot.

Cancelling part of Lot 1003 on SP298957 and  
Lots 1 & 2 on RP79384  
Locality of Narangba

- These notes form an integral part of this plan. No part of this plan may be reproduced without these notes being included.
- All dimensions and areas shown are subject to final survey and relevant local authority approval.
- This plan has been prepared for issue to a buyer as a disclosure plan under the Land Sales Act 1984. It is not to be used for any other purpose.
- Levels and contours shown on this plan are not to be used for building design or construction; a topographical survey of the site is required.
- Any engineering detail (retaining walls, etc.) shown on this plan is indicative only and subject to construction and relevant local authority approval.
- For further detail regarding services, facilities and features which may have relevance to the proposed lot, reference should be made to the Development Application approval conditions, the approved operational works drawings and current engineering drawings.

Contour Interval – 0.5 metre

—50.0—

Design Contours

Retaining Wall (Due to plotting limitations the retaining walls shown are not to scale and are indicative only)

HW 1.0

LW 0.2

AW 0.8

Height of Highest Point of Wall (Metres)

Height of Lowest Point of Wall (Metres)

Average Height of Wall (Metres)

Compaction of fill will be done in accordance with Australian Standard AS 3798—2007, under Level 1 inspection and testing by the nominated Geotechnical Inspection and Testing Authority.

x 0.1

Cut/Fill, calculated between design and existing surface contours

Area to be Cut, as supplied by RMA Engineers

Area to be Filled, as supplied by RMA Engineers

Lot levels and earthworks derived from Engineering Drawings.

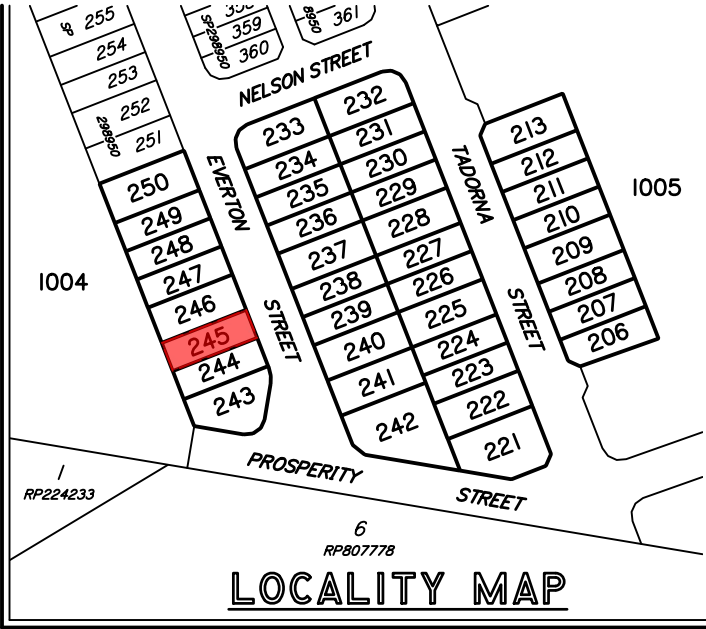
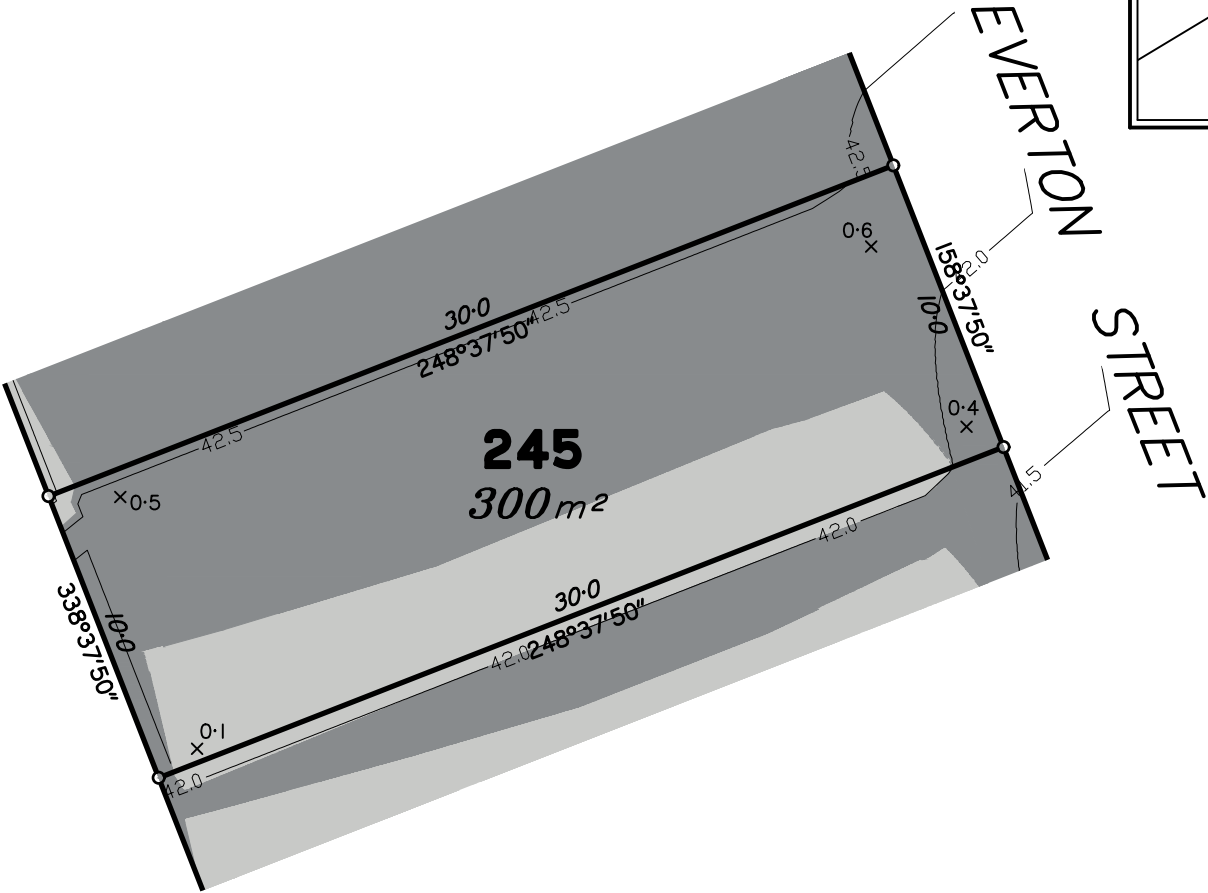

Scale 1:250 – Lengths are in Metres.

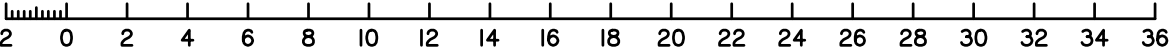

Meridian: MGA Zone 56 ☒ Yes ☐ No Contour Height Datum: AHD

dts

urban planning, surveying & development

Brisbane

Mackay

PO Box 3128, West End QLD 4101 PO Box 11711, Mackay Caneland QLD 4740

Ph: 07 3118 0600 Ph: 1300 278 783

brisbane@dtsqld.com.au mackay@dtsqld.com.au

B A	UPDATE CIVIL DESIGN INFORMATION ORIGINAL ISSUE	21/07/20 15/01/20	AA AA	AV AV	DISCLOSURE PLAN DAHUA POINTCORP NARANGBA PTY LTD STAGE 8A "AMITY" CALLAGHAN ROAD, NARANGBA	Dwg No: A3—5928/245	Issue: B
						Project: BNE150725	File: B150725Dis8A.dwg
Issue	Details	Date	Drawn	Checked			

DISCLOSURE PLAN  
PROPOSED LOT 246

This plan is to be read in conjunction with the disclosure statement prepared for this lot.

Cancelling part of Lot 1003 on SP298957 and  
Lots 1 & 2 on RP79384  
Locality of Narangba

- These notes form an integral part of this plan. No part of this plan may be reproduced without these notes being included.
- All dimensions and areas shown are subject to final survey and relevant local authority approval.
- This plan has been prepared for issue to a buyer as a disclosure plan under the Land Sales Act 1984. It is not to be used for any other purpose.
- Levels and contours shown on this plan are not to be used for building design or construction; a topographical survey of the site is required.
- Any engineering detail (retaining walls, etc.) shown on this plan is indicative only and subject to construction and relevant local authority approval.
- For further detail regarding services, facilities and features which may have relevance to the proposed lot, reference should be made to the Development Application approval conditions, the approved operational works drawings and current engineering drawings.

Contour Interval – 0.5 metre

- 50.0— Design Contours
- Retaining Wall (Due to plotting limitations the retaining walls shown are not to scale and are indicative only)
- HW 1.0  
LW 0.2  
AW 0.8
- Height of Highest Point of Wall (Metres)  
Height of Lowest Point of Wall (Metres)  
Average Height of Wall (Metres)

Compaction of fill will be done in accordance with Australian Standard AS 3798–2007, under Level 1 inspection and testing by the nominated Geotechnical Inspection and Testing Authority.

- x0.1 Cut/Fill, calculated between design and existing surface contours
- Area to be Cut, as supplied by RMA Engineers
- Area to be Filled, as supplied by RMA Engineers

Lot levels and earthworks derived from Engineering Drawings.

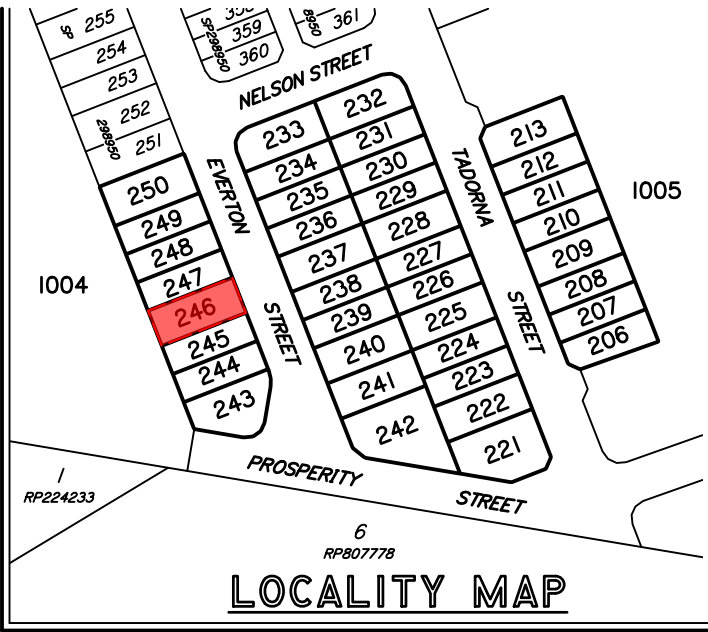
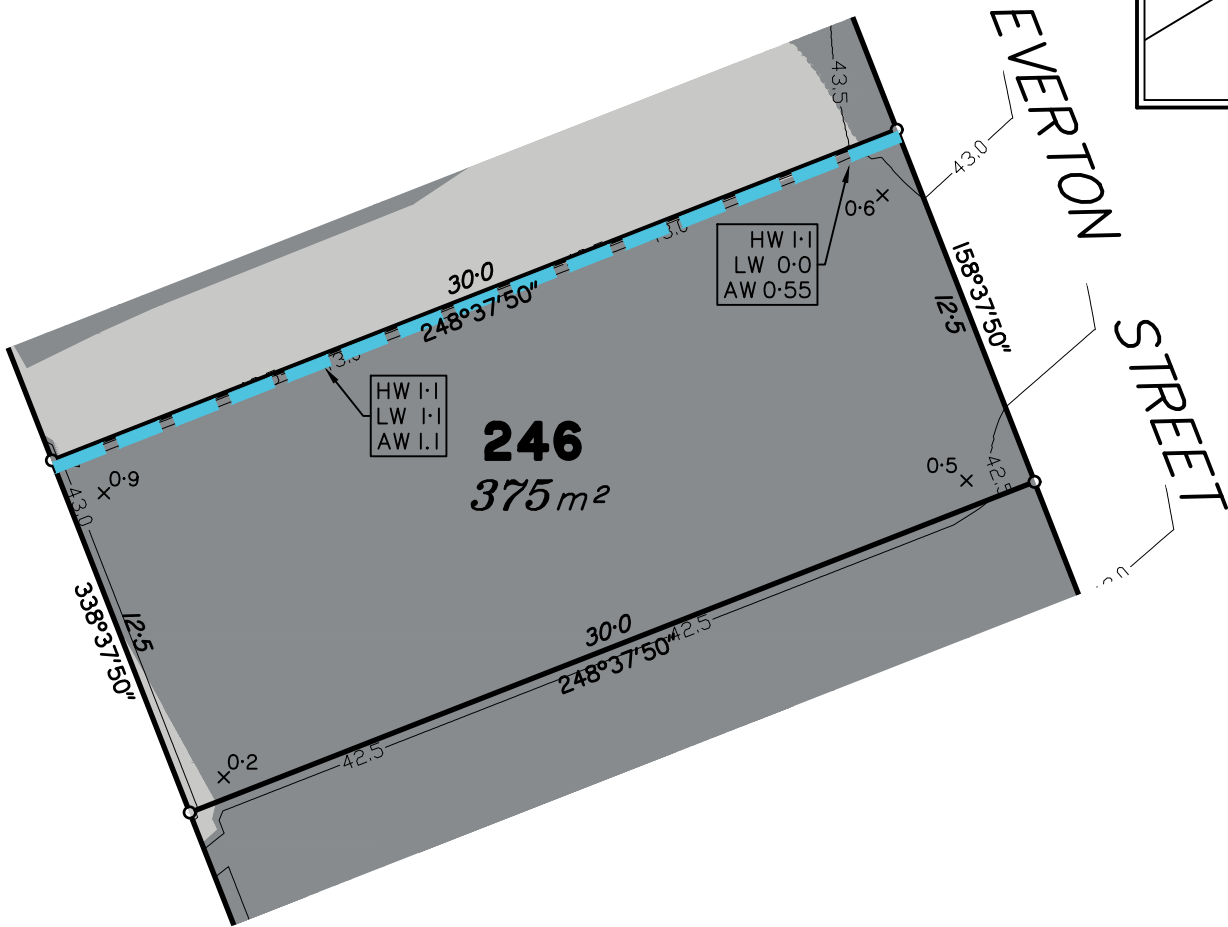

Scale 1:250 – Lengths are in Metres.

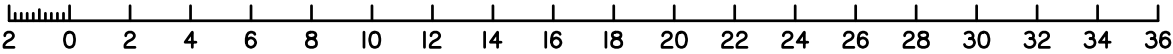

Meridian: MGA Zone 56 ☒ Yes ☐ No  
Contour Height Datum: AHD

B A	UPDATE CIVIL DESIGN INFORMATION ORIGINAL ISSUE	21/07/20 15/01/20	AA AA	AV AV	DISCLOSURE PLAN DAHUA POINTCORP NARANGBA PTY LTD STAGE 8A "AMITY" CALLAGHAN ROAD, NARANGBA	Dwg No: A3–5928/246	Issue: B
						Project: BNE150725	File: B150725Dis8A.dwg
Issue	Details	Date	Drawn	Checked			

DISCLOSURE PLAN  
PROPOSED LOT 247

This plan is to be read in conjunction with the disclosure statement prepared for this lot.

Cancelling part of Lot 1003 on SP298957 and  
Lots 1 & 2 on RP79384  
Locality of Narangba

- These notes form an integral part of this plan. No part of this plan may be reproduced without these notes being included.
- All dimensions and areas shown are subject to final survey and relevant local authority approval.
- This plan has been prepared for issue to a buyer as a disclosure plan under the Land Sales Act 1984. It is not to be used for any other purpose.
- Levels and contours shown on this plan are not to be used for building design or construction; a topographical survey of the site is required.
- Any engineering detail (retaining walls, etc.) shown on this plan is indicative only and subject to construction and relevant local authority approval.
- For further detail regarding services, facilities and features which may have relevance to the proposed lot, reference should be made to the Development Application approval conditions, the approved operational works drawings and current engineering drawings.

Contour Interval – 0.5 metre

—50.0— Design Contours  
Retaining Wall (Due to plotting limitations the retaining walls shown are not to scale and are indicative only)

HW 1.0  
LW 0.2  
AW 0.8

Height of Highest Point of Wall (Metres)  
Height of Lowest Point of Wall (Metres)  
Average Height of Wall (Metres)

Compaction of fill will be done in accordance with Australian Standard AS 3798–2007, under Level 1 inspection and testing by the nominated Geotechnical Inspection and Testing Authority.

x 0.1 Cut/Fill, calculated between design and existing surface contours

Area to be Cut, as supplied by RMA Engineers

Area to be Filled, as supplied by RMA Engineers

Lot levels and earthworks derived from Engineering Drawings.

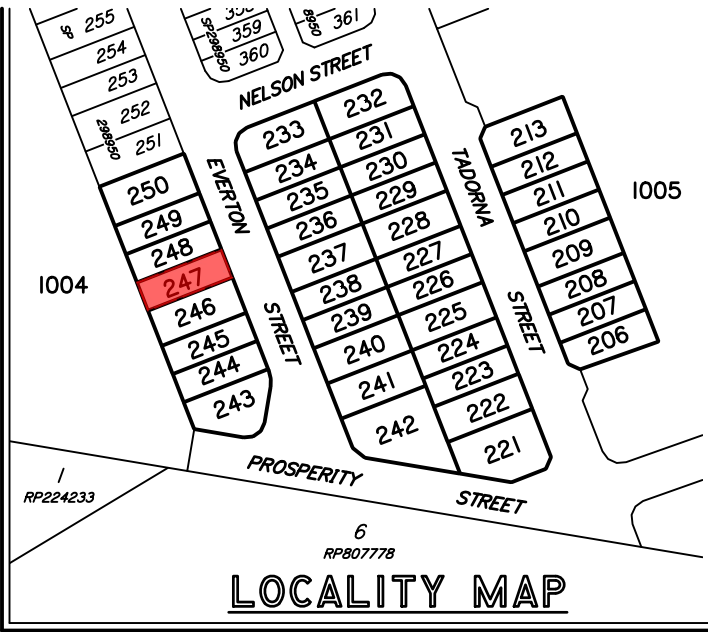
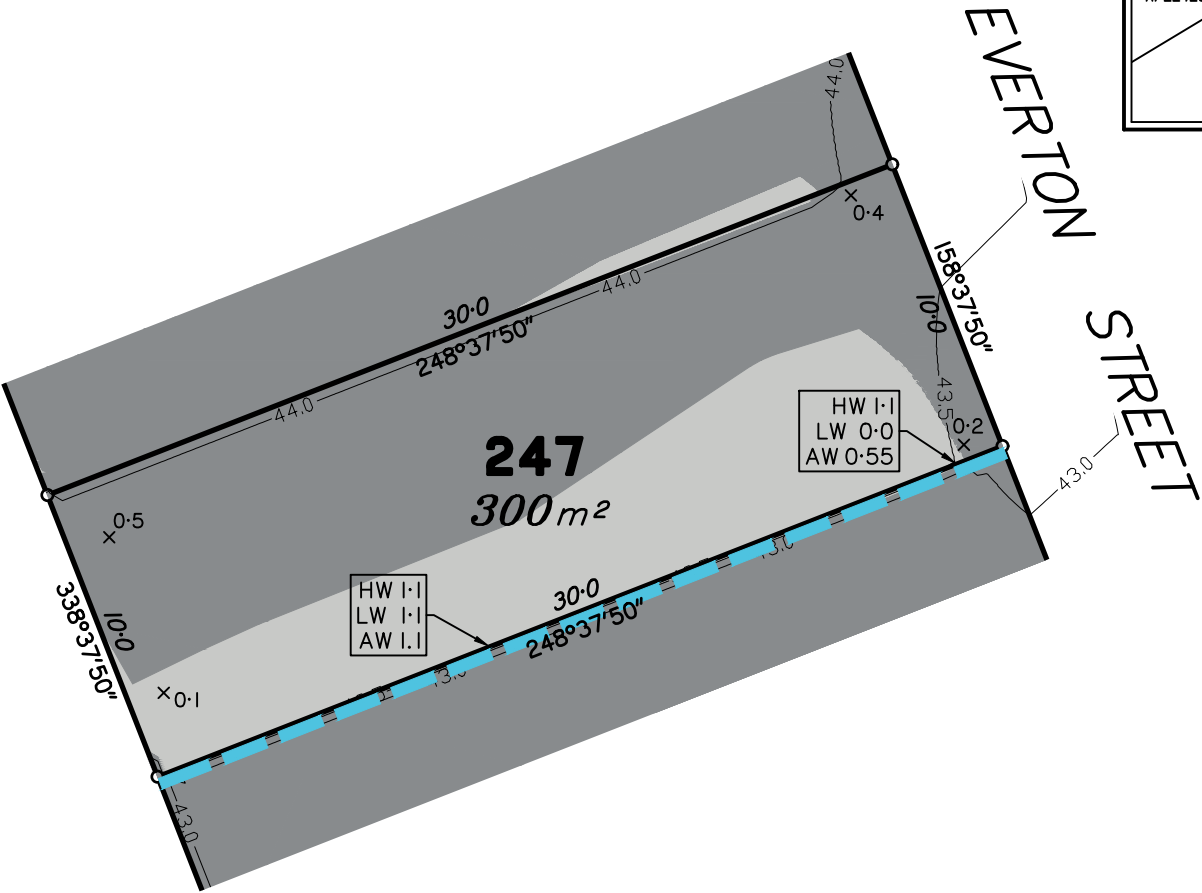

Scale 1:250 – Lengths are in Metres.

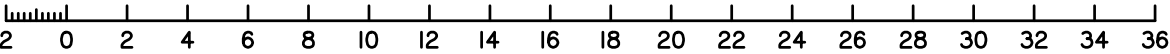

Meridian: MGA Zone 56 ☒ Yes ☐ No  
Contour Height Datum: AHD

B A	UPDATE CIVIL DESIGN INFORMATION ORIGINAL ISSUE	21/07/20 15/01/20	AA AA	AV AV	DISCLOSURE PLAN DAHUA POINTCORP NARANGBA PTY LTD STAGE 8A "AMITY" CALLAGHAN ROAD, NARANGBA	Dwg No: A3–5928/247	Issue: B
						Project: BNE150725	File: B150725Dis8A.dwg
Issue	Details	Date	Drawn	Checked			

DISCLOSURE PLAN  
PROPOSED LOT 248

This plan is to be read in conjunction with the disclosure statement prepared for this lot.

Cancelling part of Lot 1003 on SP298957 and  
Lots 1 & 2 on RP79384  
Locality of Narangba

- These notes form an integral part of this plan. No part of this plan may be reproduced without these notes being included.
- All dimensions and areas shown are subject to final survey and relevant local authority approval.
- This plan has been prepared for issue to a buyer as a disclosure plan under the Land Sales Act 1984. It is not to be used for any other purpose.
- Levels and contours shown on this plan are not to be used for building design or construction; a topographical survey of the site is required.
- Any engineering detail (retaining walls, etc.) shown on this plan is indicative only and subject to construction and relevant local authority approval.
- For further detail regarding services, facilities and features which may have relevance to the proposed lot, reference should be made to the Development Application approval conditions, the approved operational works drawings and current engineering drawings.

Contour Interval – 0.5 metre

—50.0—

Design Contours

Retaining Wall (Due to plotting limitations the retaining walls shown are not to scale and are indicative only)

HW 1.0

LW 0.2

AW 0.8

Height of Highest Point of Wall (Metres)

Height of Lowest Point of Wall (Metres)

Average Height of Wall (Metres)

Compaction of fill will be done in accordance with Australian Standard AS 3798—2007, under Level 1 inspection and testing by the nominated Geotechnical Inspection and Testing Authority.

x 0.1

Cut/Fill, calculated between design and existing surface contours

Area to be Cut, as supplied by RMA Engineers

Area to be Filled, as supplied by RMA Engineers

Lot levels and earthworks derived from Engineering Drawings.

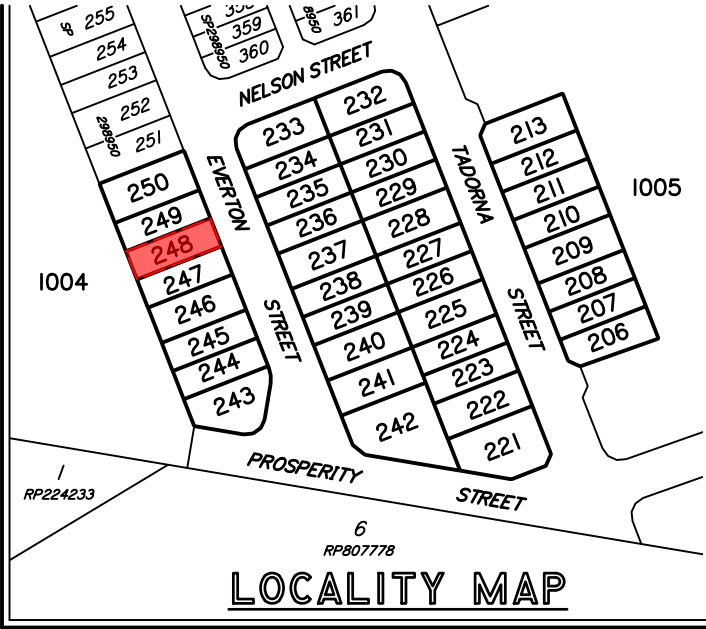
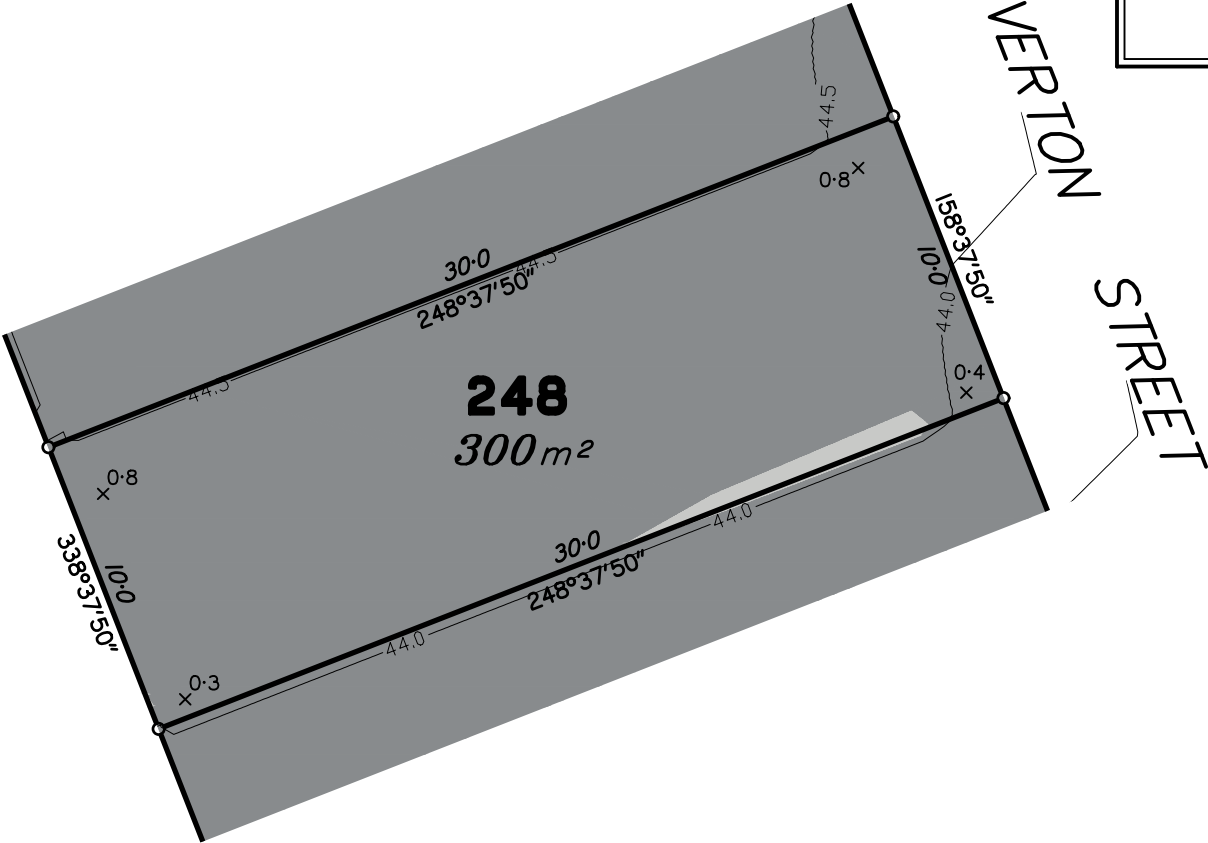

Scale 1:250 – Lengths are in Metres.

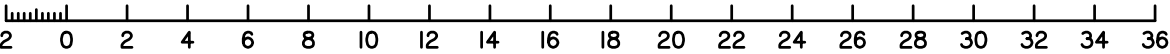

Meridian: MGA Zone 56 ☒ Yes ☐ No  
Contour Height Datum: AHD

Urban planning, surveying & development

Brisbane

Mackay

PO Box 3128, West End QLD 4101  
Ph: 07 3118 0600  
brisbane@dtsqld.com.au

PO Box 11711, Mackay Caneland QLD 4740  
Ph: 1300 278 783  
mackay@dtsqld.com.au

B A	UPDATE CIVIL DESIGN INFORMATION ORIGINAL ISSUE	21/07/20 15/01/20	AA AA	AV AV	DISCLOSURE PLAN DAHUA POINTCORP NARANGBA PTY LTD STAGE 8A "AMITY" CALLAGHAN ROAD, NARANGBA	Dwg No: A3—5928/248	Issue: B
						Project: BNE150725	File: B150725Dis8A.dwg
Issue	Details	Date	Drawn	Checked			



DISCLOSURE PLAN  
PROPOSED LOT 249

This plan is to be read in conjunction with the disclosure statement prepared for this lot.

Cancelling part of Lot 1003 on SP298957 and  
Lots 1 & 2 on RP79384  
Locality of Narangba

- These notes form an integral part of this plan. No part of this plan may be reproduced without these notes being included.
- All dimensions and areas shown are subject to final survey and relevant local authority approval.
- This plan has been prepared for issue to a buyer as a disclosure plan under the Land Sales Act 1984. It is not to be used for any other purpose.
- Levels and contours shown on this plan are not to be used for building design or construction; a topographical survey of the site is required.
- Any engineering detail (retaining walls, etc.) shown on this plan is indicative only and subject to construction and relevant local authority approval.
- For further detail regarding services, facilities and features which may have relevance to the proposed lot, reference should be made to the Development Application approval conditions, the approved operational works drawings and current engineering drawings.

Contour Interval – 0.5 metre

—50.0—

Design Contours

Retaining Wall (Due to plotting limitations the retaining walls shown are not to scale and are indicative only)

HW 1.0

LW 0.2

AW 0.8

Height of Highest Point of Wall (Metres)

Height of Lowest Point of Wall (Metres)

Average Height of Wall (Metres)

Compaction of fill will be done in accordance with Australian Standard AS 3798—2007, under Level 1 inspection and testing by the nominated Geotechnical Inspection and Testing Authority.

x 0.1

Cut/Fill, calculated between design and existing surface contours

Area to be Cut, as supplied by RMA Engineers

Area to be Filled, as supplied by RMA Engineers

Lot levels and earthworks derived from Engineering Drawings.

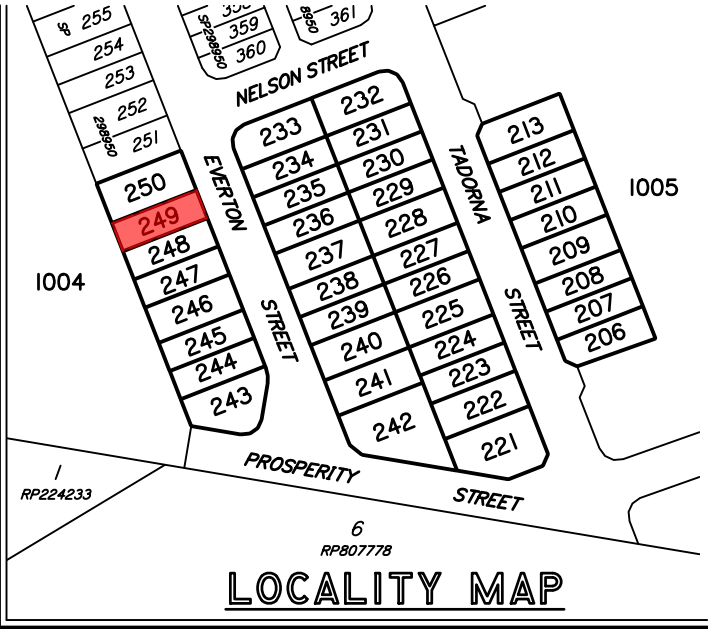
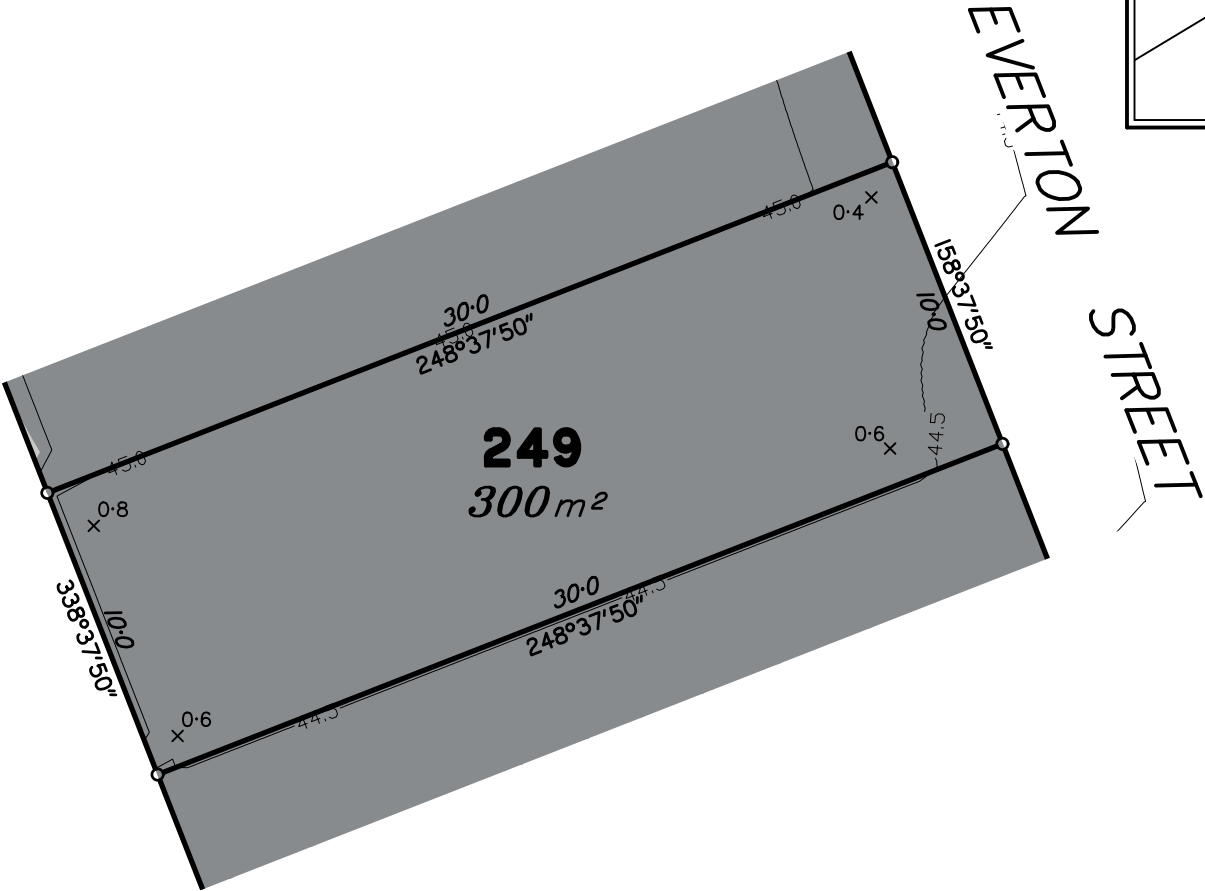

Scale 1:250 – Lengths are in Metres.

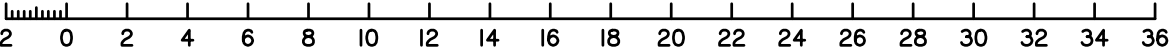

Meridian: MGA Zone 56 ☒ Yes ☐ No  
Contour Height Datum: AHD

dts

urban planning, surveying & development

Brisbane

Mackay

PO Box 3128, West End QLD 4101 PO Box 11711, Mackay Caneland QLD 4740

Ph: 07 3118 0600 Ph: 1300 278 783

brisbane@dtsqld.com.au mackay@dtsqld.com.au

B	UPDATE CIVIL DESIGN INFORMATION	21/07/20	AA	AV
A	ORIGINAL ISSUE	15/01/20	AA	AV
Issue	Details	Date	Drawn	Checked

DISCLOSURE PLAN  
DAHUA POINTCORP NARANGBA PTY LTD  
STAGE 8A "AMITY"  
CALLAGHAN ROAD, NARANGBA

Dwg No:	A3–5928/249	Issue:	B
Project:	BNE150725		
File:	B150725Dis8A.dwg		

DISCLOSURE PLAN  
PROPOSED LOT 250

This plan is to be read in conjunction with the disclosure statement prepared for this lot.

Cancelling part of Lot 1003 on SP298957 and  
Lots 1 & 2 on RP79384  
Locality of Narangba

- These notes form an integral part of this plan. No part of this plan may be reproduced without these notes being included.
- All dimensions and areas shown are subject to final survey and relevant local authority approval.
- This plan has been prepared for issue to a buyer as a disclosure plan under the Land Sales Act 1984. It is not to be used for any other purpose.
- Levels and contours shown on this plan are not to be used for building design or construction; a topographical survey of the site is required.
- Any engineering detail (retaining walls, etc.) shown on this plan is indicative only and subject to construction and relevant local authority approval.
- For further detail regarding services, facilities and features which may have relevance to the proposed lot, reference should be made to the Development Application approval conditions, the approved operational works drawings and current engineering drawings.

Contour Interval – 0.5 metre

—50.0—

Design Contours

Retaining Wall (Due to plotting limitations the retaining walls shown are not to scale and are indicative only)

HW 1.0

LW 0.2

AW 0.8

Height of Highest Point of Wall (Metres)

Height of Lowest Point of Wall (Metres)

Average Height of Wall (Metres)

Compaction of fill will be done in accordance with Australian Standard AS 3798—2007, under Level 1 inspection and testing by the nominated Geotechnical Inspection and Testing Authority.

x 0.1

Cut/Fill, calculated between design and existing surface contours

Area to be Cut, as supplied by RMA Engineers

Area to be Filled, as supplied by RMA Engineers

Lot levels and earthworks derived from Engineering Drawings.

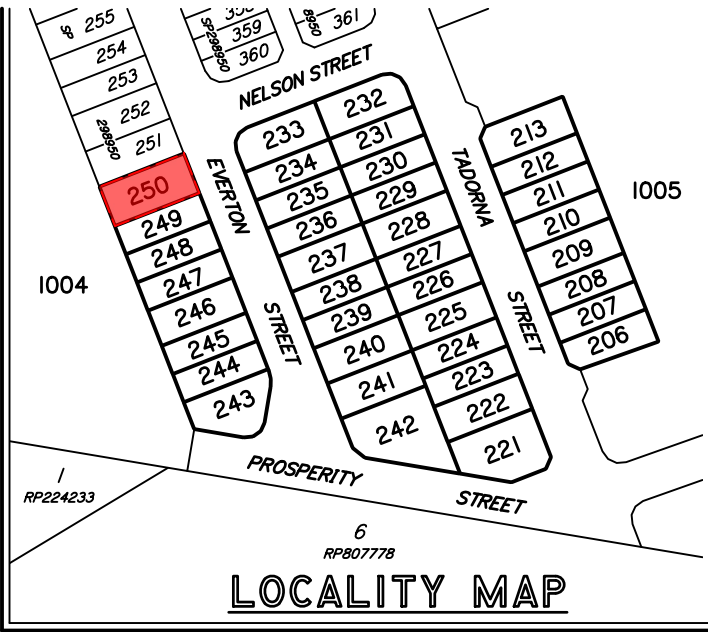
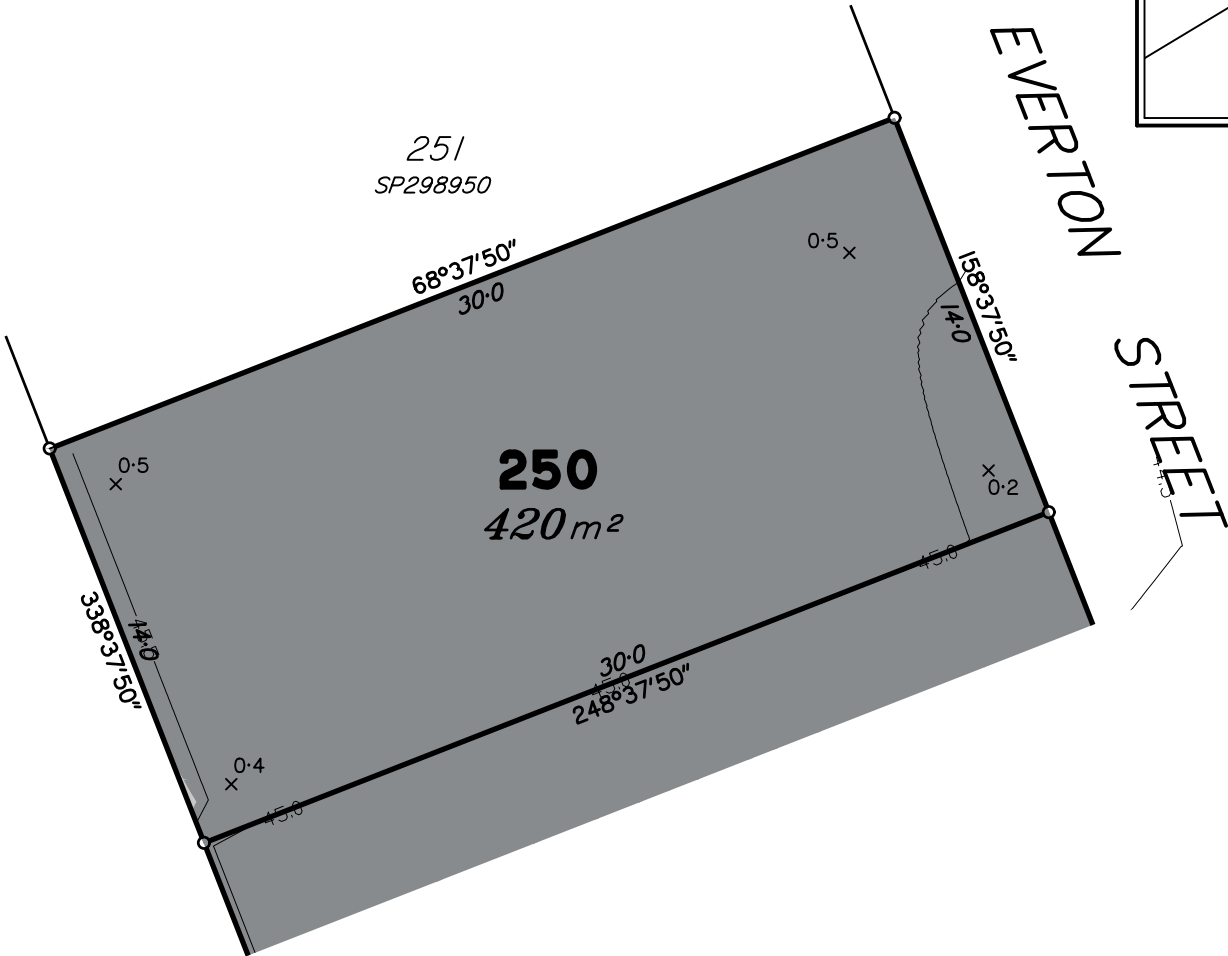

Scale 1:250 – Lengths are in Metres.

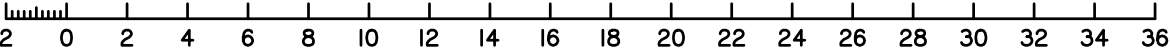

Meridian: MGA Zone 56 ☒ Yes ☐ No Contour Height Datum: AHD

Urban planning, surveying & development

Brisbane

Mackay

PO Box 3128, West End QLD 4101  
Ph: 07 3118 0600  
brisbane@dtsqld.com.au

PO Box 11711, Mackay Caneland QLD 4740  
Ph: 1300 278 783  
mackay@dtsqld.com.au

B A	UPDATE CIVIL DESIGN INFORMATION ORIGINAL ISSUE	21/07/20 15/01/20	AA AA	AV AV	DISCLOSURE PLAN DAHUA POINTCORP NARANGBA PTY LTD STAGE 8A "AMITY" CALLAGHAN ROAD, NARANGBA	Dwg No: A3–5928/250	Issue: B
						Project: BNE150725	File: B150725Dis8A.dwg
Issue	Details	Date	Drawn	Checked			