

**COORDINATE DATUM NOTE:**  
 HORIZONTAL COORDINATES(E,N) SUPPLIED ARE MAPPING GRID OF AUSTRALIA(MGA), ZONE 56 BASED ON THE UNIVERSAL TRANSVERSE MERCATOR PROJECTION AND THE GEOCENTRIC DATUM OF AUSTRALIA 1994.  
 HORIZONTAL DATUM DERIVED FROM PSM52870, E 496223.382, N 6992682.075.  
 LEVELS SUPPLIED ARE ON THE AUSTRALIAN HEIGHT DATUM(AHD).  
 LEVEL DATUM DERIVED FROM PSM52870 RL 44.140 (AHD)

PSM52870  
 E: 496223.382  
 N: 6992682.075  
 RL: 44.140m

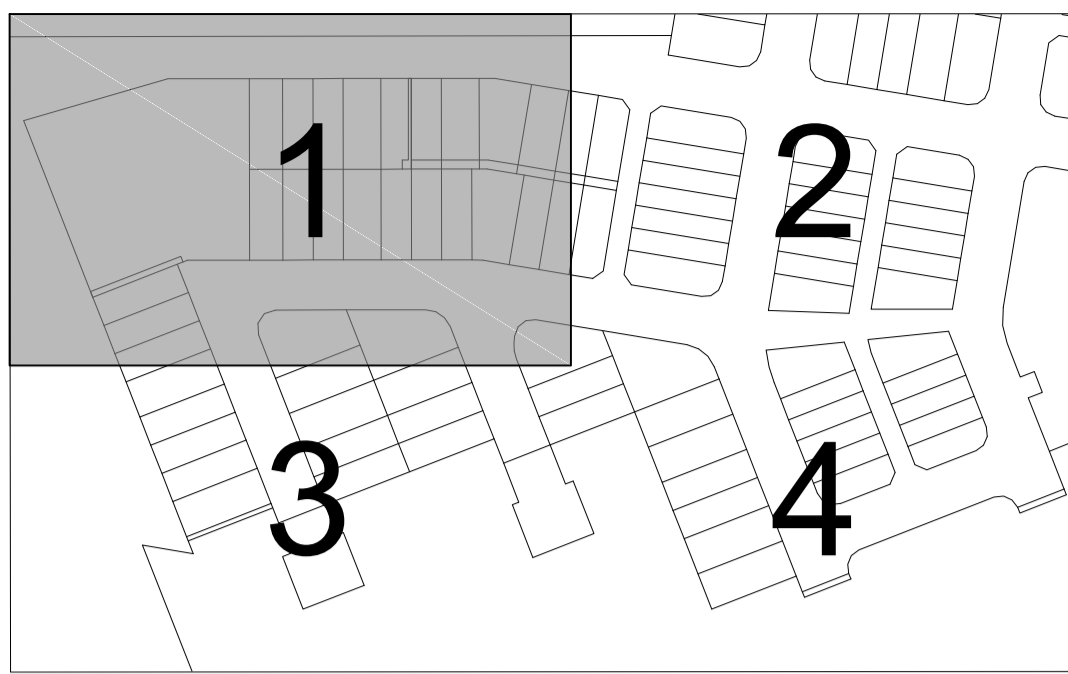

**KEY PLAN**  
 Scale 1: 2500

**Legend**

- NEW PVC-O PN16 WATER MAIN
- 100ø uPVC PN9 ROAD CROSSING
- EXISTING WATER MAIN
- BEND
- FIRE HYDRANT
- ⊗ VALVE
- READY TAP
- END CAP
- WATER METER

- ① 100ø x 11.25° BEND
- ② 100ø x 22.5° BEND
- ③ 100ø x 45° BEND
- ④ 100ø x 90° BEND
- ⑤ 100ø x 100ø TEE
- ⑥ 100ø HYDRANT
- ⑦ 100ø SLUICE VALVE
- ⑧ 100ø END CAP

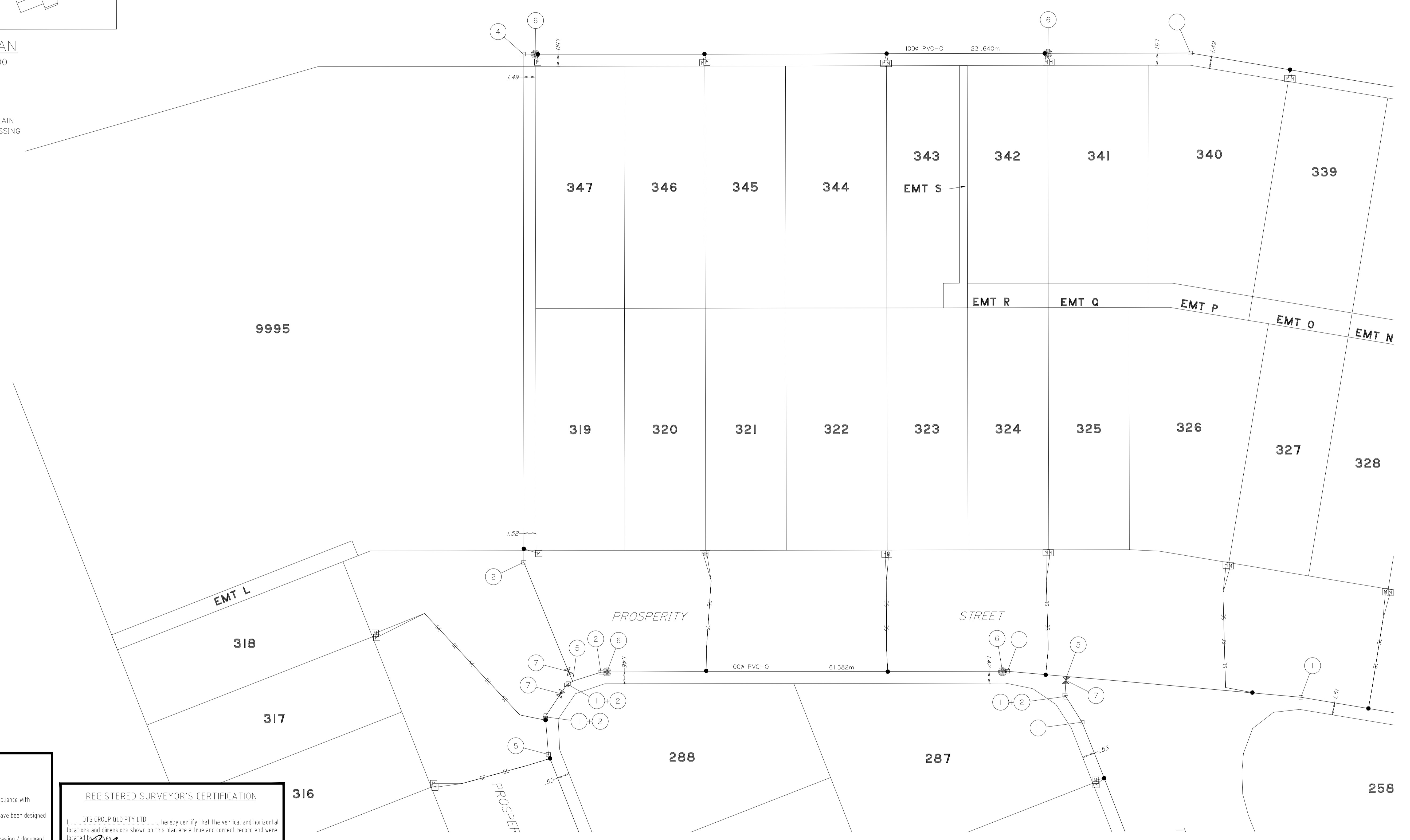

**ENGINEER'S CERTIFICATION**  
 I, **Justin Holzheimer**, hereby certify that:  
 1. The information contained in this drawing / document is in compliance with approved drawings and design.  
 2. The new water and sewerage works defined by this drawing have been designed and constructed in accordance with the SEQ Code.  
 3. This represents an accurate record of as-constructed works.  
 4. I accept responsibility for the information contained in this drawing / document.  
 RPED (signature) RPED No. **16948** Date: **15/03/2019**

**REGISTERED SURVEYOR'S CERTIFICATION**  
 I, **DTS GROUP QLD PTY LTD**, hereby certify that the vertical and horizontal locations and dimensions shown on this plan are a true and correct record and were located by me.  
 Registered Surveyor (sig) Reg. Surveyor No. **3115** Date: **13/03/2019**

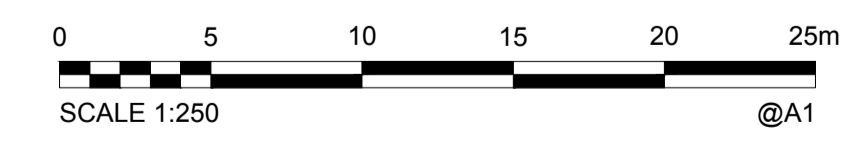

**AS CONSTRUCTED**

<b>A1</b>	INDEX	DATE	AS CONSTRUCTED - ORIGINAL ISSUE	AA	JS	TL	DRAWN	AA	13/03/2019
	REVISIONS	DATE	REVISIONS	DRAWN	CHECKED	PASSED	INITIALS	DATE	

**dts** urban planning, surveying & development  
 Brisbane PO Box 3128, West End QLD 4101  
 Mackay PO Box 11711, Mackay Queensland QLD 4740  
 Ph: 07 3118 0500  
 brisbane@dtsqld.com.au  
 mackay@dtsqld.com.au



**Unitywater**  
 AS CONSTRUCTED WATER  
 AMITY NARANGBA - STAGES 3 & 10  
 BURPENGARY & CALLAGHAN ROADS, NARANGBA

SHEET 5 OF 8 SHEETS	SCALE 250
REVISION DATE 13/03/2019	REVISION A
DISCIPLINE CODE	
DRAWING NO. U-2018-0805	

**COORDINATE DATUM NOTE:**  
 HORIZONTAL COORDINATES(E,N) SUPPLIED ARE MAPPING GRID OF AUSTRALIA(MGA), ZONE 56 BASED ON THE UNIVERSAL TRANSVERSE MERCATOR PROJECTION AND THE GEOCENTRIC DATUM OF AUSTRALIA 1994.  
 HORIZONTAL DATUM DERIVED FROM PSM52870, E 496223.382, N 6992682.075.  
 LEVELS SUPPLIED ARE ON THE AUSTRALIAN HEIGHT DATUM(AHD).  
 LEVEL DATUM DERIVED FROM PSM52870 RL 4.4.140 (AHD)

**Legend**

- NEW PVC-O PN16 WATER MAIN
- 100ø uPVC PN9 ROAD CROSSING
- EXISTING WATER MAIN
- BEND
- FIRE HYDRANT
- ⊗ VALVE
- READY TAP
- END CAP
- ⊠ WATER METER

- ① 100ø x 11.25° BEND
- ② 100ø x 22.5° BEND
- ③ 100ø x 45° BEND
- ④ 100ø x 90° BEND
- ⑤ 100ø x 100ø TEE
- ⑥ 100ø HYDRANT
- ⑦ 100ø SLUICE VALVE
- ⑧ 100ø END CAP

PSM52870  
 E: 496223.382  
 N: 6992682.075  
 RL: 4.4.140m

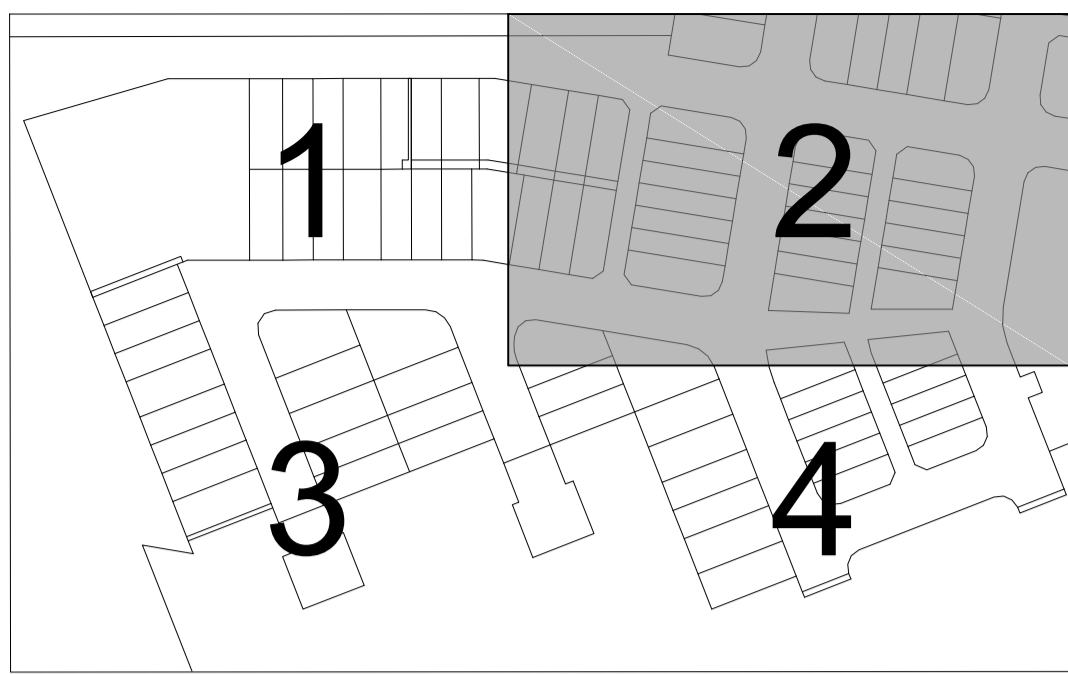

**KEY PLAN**  
 Scale 1:2500



**ENGINEER'S CERTIFICATION**  
 I, **Justin Holzheimer**, hereby certify that:  
 1. The information contained in this drawing / document is in compliance with approved drawings and design.  
 2. The new water and sewerage works defined by this drawing have been designed and constructed in accordance with the SEQ Code.  
 3. This represents an accurate record of as-constructed works.  
 4. I accept responsibility for the information contained in this drawing / document.  
 RPED (signature) RPED No. **16948** Date: **15/03/2019**

**REGISTERED SURVEYOR'S CERTIFICATION**  
 I, **DTS GROUP QLD PTY LTD**, hereby certify that the vertical and horizontal locations and dimensions shown on this plan are a true and correct record and were located by me.  
 Registered Surveyor (sig) Reg Surveyor No. **3115** Date: **13/03/2019**

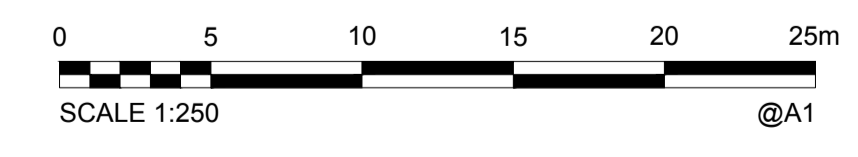

**AS CONSTRUCTED**

<b>A1</b>	INDEX	DATE	AS CONSTRUCTED - ORIGINAL ISSUE	DRAWN	CHECKED	PASSED	INITIALS	DATE
	A	13/03/2019	AS CONSTRUCTED - ORIGINAL ISSUE	AA	JS	TL		

DRAWN	AA	13/03/2019
CHECKED	JS	13/03/2019
PASSED	TL	13/03/2019



**Unitywater**  
 AS CONSTRUCTED WATER  
 AMITY NARANGBA - STAGES 3 & 10  
 BURPENGARY & CALLAGHAN ROADS, NARANGBA

SHEET 6 OF 8 SHEETS	SCALE 250
REVISION DATE 13/03/2019	REVISION A
DISCIPLINE CODE	
DRAWING NO. U-2018-0805	

PSM52870  
 E: 496223.382  
 N: 6992682.075  
 RL: 4.4.14.0m

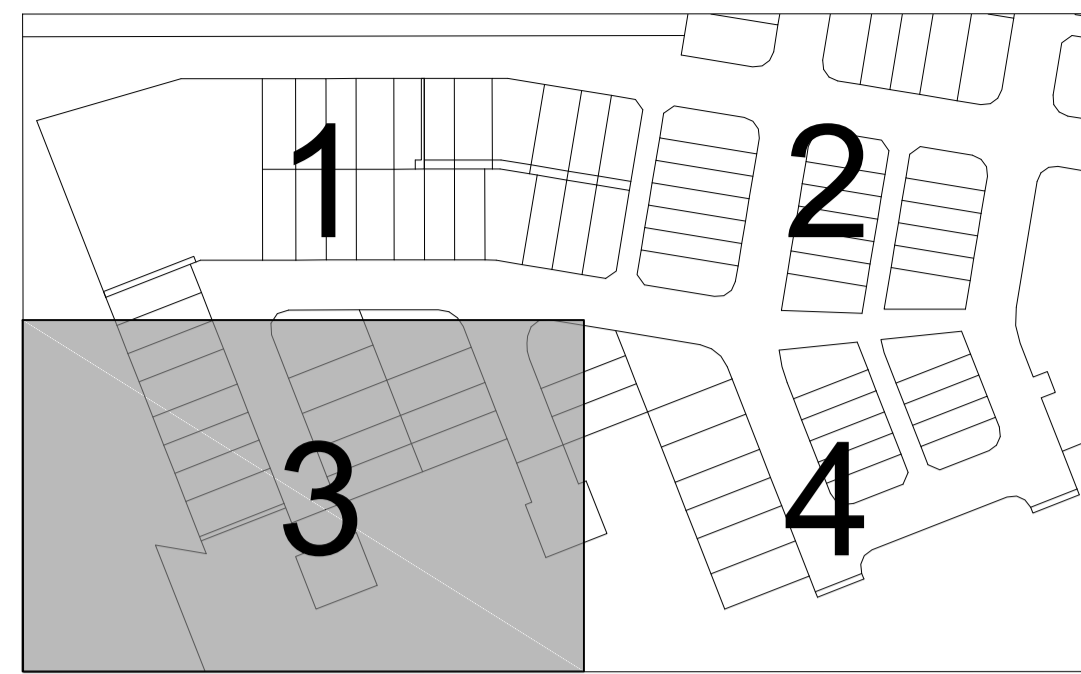

**KEY PLAN**  
 Scale 1: 2500

**Legend**

- NEW PVC-O PN16 WATER MAIN
- sc 100Ø uPVC PN9 ROAD CROSSING
- EXISTING WATER MAIN
- BEND
- FIRE HYDRANT
- ⊗ VALVE
- READY TAP
- END CAP
- ⊞ WATER METER

- ① 100Ø x 11.25° BEND
- ② 100Ø x 22.5° BEND
- ③ 100Ø x 45° BEND
- ④ 100Ø x 90° BEND
- ⑤ 100Ø x 100Ø TEE
- ⑥ 100Ø HYDRANT
- ⑦ 100Ø SLUICE VALVE
- ⑧ 100Ø END CAP

BURPENGARY



Water Meter for Lot 293 to be installed as part of works for future stage

Water Meters for Lots 282 & 283 to be installed as part of works for future stage

**COORDINATE DATUM NOTE:**  
 HORIZONTAL COORDINATES(E,N) SUPPLIED ARE MAPPING GRID OF AUSTRALIA(MGA), ZONE 56 BASED ON THE UNIVERSAL TRANSVERSE MERCATOR PROJECTION AND THE GEOCENTRIC DATUM OF AUSTRALIA 1994.  
 HORIZONTAL DATUM DERIVED FROM PSM52870, E 496223.382, N 6992682.075.  
 LEVELS SUPPLIED ARE ON THE AUSTRALIAN HEIGHT DATUM(AHD).  
 LEVEL DATUM DERIVED FROM PSM52870 RL 4.4.14.0 (AHD)

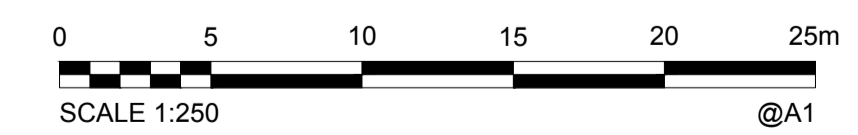

**AS CONSTRUCTED**

**ENGINEER'S CERTIFICATION**  
 I, Justin Holzheimer, hereby certify that:  
 1. The information contained in this drawing / document is in compliance with approved drawings and design.  
 2. The new water and sewerage works defined by this drawing have been designed and constructed in accordance with the SEQ Code.  
 3. This represents an accurate record of as-constructed works.  
 4. I accept responsibility for the information contained in this drawing / document.  
 RPED (signature) RPED No. 16948 Date: 15/03/2019

**REGISTERED SURVEYOR'S CERTIFICATION**  
 I, DTS GROUP QLD PTY LTD, hereby certify that the vertical and horizontal locations and dimensions shown on this plan are a true and correct record and were located by me.  
 Registered Surveyor (sig) Reg. Surveyor No. 3115 Date: 13/03/2019

<b>A1</b>	INDEX	DATE	AS CONSTRUCTED - ORIGINAL ISSUE	AA	JS	TL	DRAWN	AA	13/03/2019
	INDEX	DATE	REVISIONS	DRAWN	CHECKED	PASSED	INITIALS	DATE	

**dts** urban planning, surveying & development  
 Brisbane PO Box 3128, West End QLD 4101  
 Mackay PO Box 11711, Mackay Queensland QLD 4740  
 Ph: 07 3118 0500  
 Brisbane@dtsgroup.com.au Mackay@dtsgroup.com.au



**Unitywater**  
 AS CONSTRUCTED WATER  
 AMITY NARANGBA - STAGES 3 & 10  
 BURPENGARY & CALLAGHAN ROADS, NARANGBA

SHEET 7 OF 8 SHEETS	SCALE 250
REVISION DATE 13/03/2019	REVISION A
DISCIPLINE CODE	
DRAWING NO. U-2018-0805	

PSM52870  
 E: 496223.382  
 N: 6992682.075  
 RL: 4.4.14.0m

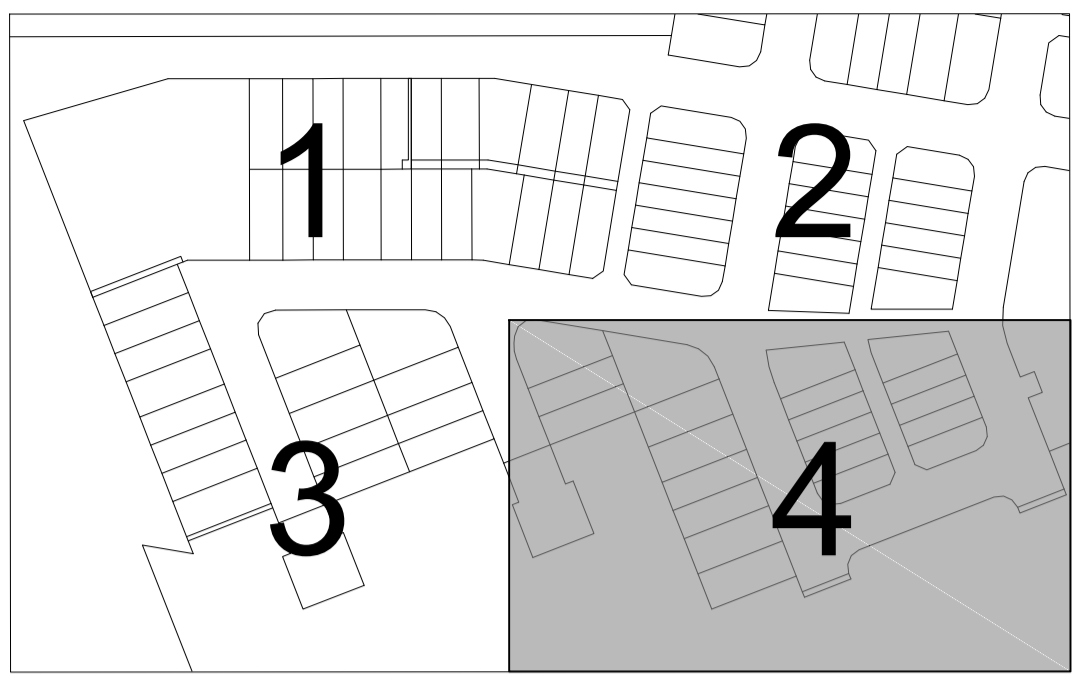

KEY PLAN  
 Scale 1: 2500



- Legend**
- NEW PVC-0 PN16 WATER MAIN
  - sc 100ø uPVC PN9 ROAD CROSSING
  - w EXISTING WATER MAIN
  - BEND
  - FIRE HYDRANT
  - ⊕ VALVE
  - ⊙ READY TAP
  - ⊖ END CAP
  - ⊞ WATER METER

- ① 100ø x 11.25° BEND
- ② 100ø x 22.5° BEND
- ③ 100ø x 45° BEND
- ④ 100ø x 90° BEND
- ⑤ 100ø x 100ø TEE
- ⑥ 100ø HYDRANT
- ⑦ 100ø SLUICE VALVE
- ⑧ 100ø END CAP

**COORDINATE DATUM NOTE:**  
 HORIZONTAL COORDINATES(E, N) SUPPLIED ARE MAPPING GRID OF AUSTRALIA(MGA), ZONE 56 BASED ON THE UNIVERSAL TRANSVERSE MERCATOR PROJECTION AND THE GEOCENTRIC DATUM OF AUSTRALIA 1994.  
 HORIZONTAL DATUM DERIVED FROM PSM52870, E 496223.382, N 6992682.075.  
 LEVELS SUPPLIED ARE ON THE AUSTRALIAN HEIGHT DATUM(AHD)  
 LEVEL DATUM DERIVED FROM PSM52870 RL 4.4.14.0 (AHD)

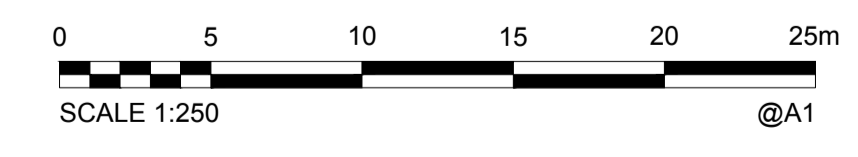

**AS CONSTRUCTED**

**ENGINEER'S CERTIFICATION**  
 I, Justin Holzheimer, hereby certify that:  
 1. The information contained in this drawing / document is in compliance with approved drawings and design.  
 2. The new water and sewerage works defined by this drawing have been designed and constructed in accordance with the SEQ Code.  
 3. This represents an accurate record of as-constructed works.  
 4. I accept responsibility for the information contained in this drawing / document.  
 RPED (signature) RPED No. 16948 Date 15/03/2019

**REGISTERED SURVEYOR'S CERTIFICATION**  
 I, DTS GROUP QLD PTY LTD, hereby certify that the vertical and horizontal locations and dimensions shown on this plan are a true and correct record and were located by me.  
 Registered Surveyor (sig) Reg. Surveyor No. 3115 Date: 13/03/2019

**A1**

INDEX	DATE	AS CONSTRUCTED - ORIGINAL ISSUE	REVISIONS	DRAWN	CHECKED	PASSED	INITIALS	DATE
A	13/03/2019	AS CONSTRUCTED - ORIGINAL ISSUE		AA	JS	TL		

**dts** urban planning, surveying & development  
 Brisbane PO Box 3128, West End QLD 4101 Ph: 07 3118 0500 brisbane@dtsqld.com.au  
 Mackay PO Box 11711, Mackay Queensland QLD 4740 Ph: 08 9390 2763 mackay@dtsqld.com.au



**Unitywater**

AS CONSTRUCTED WATER  
 AMITY NARANGBA - STAGES 3 & 10  
 BURPENGARY & CALLAGHAN ROADS, NARANGBA

SHEET 8 OF 8 SHEETS	SCALE 250
REVISION DATE 13/03/2019	REVISION A
DISCIPLINE CODE	
DRAWING NO. U-2018-0805	